

SERVICE MANUAL

Closer Relations through "CLARION SERVICE MANUAL"

MAZDA AUTOMOBILE GENUINE CAR STEREO MODEL PT-832

Manufacturer **CLARION CO., LTD.**

Export Division **CLARION SHOJI CO., LTD.**

Tel : 26512931

Telex : J22908, J22152, J25550 CLARISHO 3, Kojimachi 5-chome, Chiyoda-ku, Tokyo, 102 Japan

Overseas Sales Branch Offices :

CLARION SHOJI (EUROPA) G.m.b.H. Rudolf-Diesel-Strasse 2, 6236 Eschborn 2, West Germany Tel: 06173-61041-42 Telex: 415414
CLARION CORPORATION OF AMERICA 5500 Rosecrans Ave, Lawndale, Calif., 90260 U.S.A. Tel: 213-973-1100 Telex: CLARIONLSA 66-4447
CLARION (HONG KONG) CO., LTD. 526, Ocean Centre, Canton Road, Tsimshatsui, Kowloon, Hong Kong Tel: 3-690528 Telex: HX64293 CLAHK

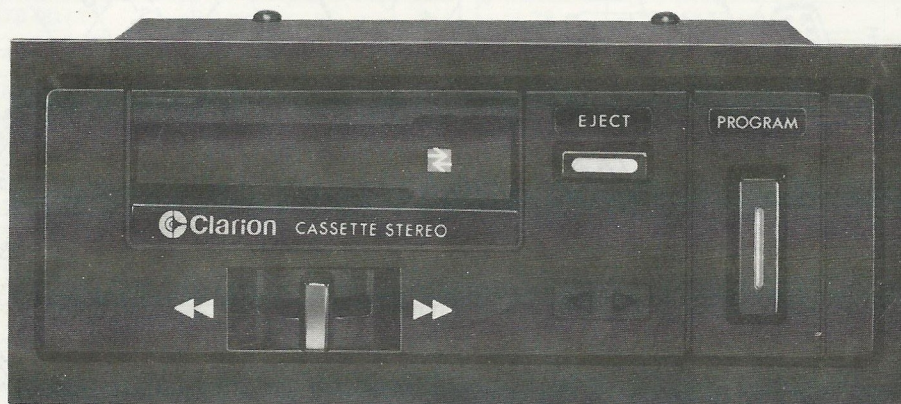

SPECIFICATIONS:

Reproduction system:	4 track, 2 program, 2 channel stereo cassette tape player (with auto reverse system)	Less than 90 seconds (C-60)
Tape speed:	4.75cm/sec.	
Wow and flutter:	Less than 0.35% (W.R.M.S)	
Output:	80mV (333Hz 0VU)	
S/N ratio:	More than 40dB	
Cross talk:	More than 30dB (adjacent channel) More than 40dB (adjacent track)	
Reproduction frequency range:	50Hz to 10,000Hz	
Fast forward and rewind time:		
		Power supply voltage: DC 13.2V Negative ground
		Current consumption: Less than 2.0A (Less than 4.5A at plunger operated)
		Load impedance: 10K Ω
		Frequency characteristic: 125Hz(1 \pm 4) to 6.300Hz(-2 \pm 5)
		Weight: 1.45kg
		Semiconductors: 2 ICs, 4 Transistors, 3 Diodes
		Dimensions: Width 140mm Height 47mm Depth 179mm

©Main section

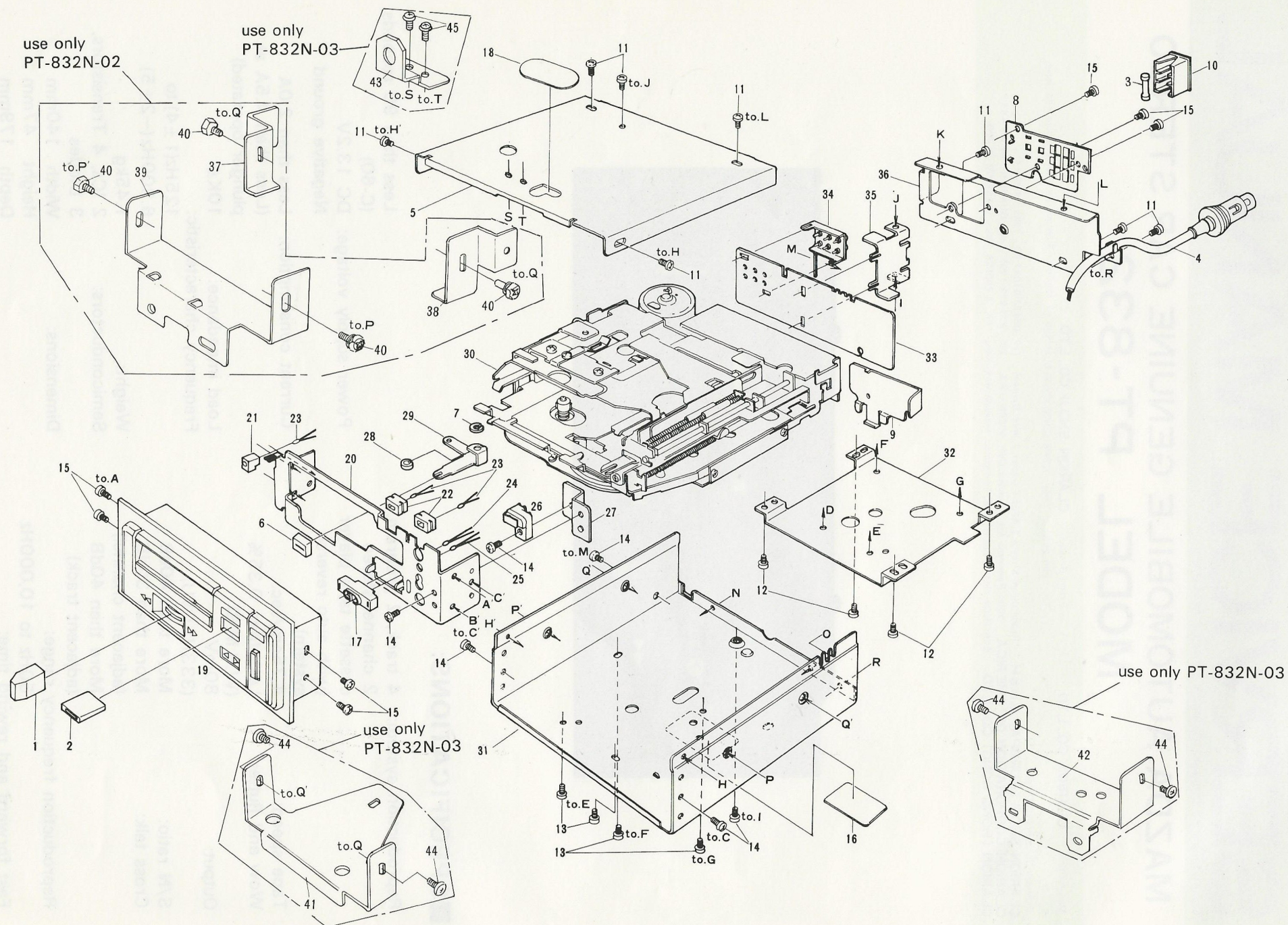

■PARTS LIST:

◎Main section

REF.NO.	PART NO. (ORDER NO.)	DESCRIPTION	Q'TY	REF.NO.	PART NO. (ORDER NO.)	DESCRIPTION	Q'TY
1	380-3605-00	Knob	1	22	345-2778-00	Pilot lamp holder	2
2	380-3604-00	Knob	1	23	017-0314-06	Pilot lamp	3
3	120-0050-02	Fuse (5A)	1	24	017-0314-07	Pilot lamp	1
4	852-5738-01	Extension lead	1	25	017-0314-08	Pilot lamp	1
5	310-0891-05 (PT-832N-02) 310-0891-08 (PT-832N-03)	Upper case	1	26	013-3264-01	Program select switch	1
6	345-2878-00	Knob cover	1	27	330-6089-00	SW mounting bracket	1
7	746-0685-00	Washer	1	28	746-0668-01	Washer	1
8	074-0601-01	Outlet socket	1	29	330-5979-00	FF, REW lever	1
9	330-6108-00	Shielded plate	1	30	930-0443-00	Tape mechanism ass'y	1
10	335-0837-00	Fuse cover	1	31	311-0901-06	Lower case	1
11	731-3006-80	Taptight (M3x6)	8	32	330-5973-04	Tape mecha. m.t.g bracket	1
12	732-3006-11	Sems screw (M3x6)	4	33	099-4746-02	P.W.B	1
13	714-3004-80	Machine screw (M3x4)	4	34	944-0482-00	Filter ass'y	1
14	714-3006-80	Machine screw (M3x6)	6	35	330-6088-00	P.W.B m.t.g bracket	1
15	731-3008-80	Taptight (M3x8)	7	36	307-0273-02	Rear cover	1
16	286-3678-00	Set plate	1	37	300-5573-01	Mounting bracket (PT-832N-02)	1
17	345-2741-00	Pilot lamp holder	1	38	300-5573-00	Mounting bracket (PT-832N-02)	1
18	290-2567-01	Label	1	39	300-5572-00	Mounting bracket (PT-832N-02)	1
19	940-0220A (PT-832N-02) 940-0237A (PT-832N-03)	Escutcheon ass'y	1	40	714-5008-81	Machine screw (M5x8) (PT-832N-02)	4
20	308-0878-01	Front cover	1	41	300-5832-00	Mounting bracket (PT-832N-03)	1
21	345-2776-02 (PT-832N-02) 345-2776-03 (PT-832N-03)	Pilot lamp holder	1	42	300-6016-00	Mounting bracket (PT-832N-03)	1
				43	300-6020-00	Mounting bracket (PT-832N-03)	1
				44	714-5008-81	Machine screw (M5x8) (PT-832N-03)	4
				45	714-3004-81	Machine screw (M3x4) (PT-832N-03)	2

◎Electrical section

REF.NO.	PART NO. (ORDER NO.)	DESCRIPTION	Q'TY	REF.NO.	PART NO. (ORDER NO.)	DESCRIPTION	Q'TY
IC _{1,51}	051-0020-00	IC(TA-7120P)	2	C ₂₀₅	165-3934-02	Ceramic capacitor (0.039μFYG)	1
Q ₂	100-0495-25	Transistor (2SA495Y)	1	R ₂₀₈	032-0018-00	Film resistor (3/4W2.2Ω)	1
Q ₃	100-0950-25	Transistor (2SA950Y)	1	R ₁₀₇	111-1021-22	Film resistor (3/8W1KΩ)	1
Q ₁	102-0372-15	Transistor (2SC372-O)	1	R ₅₅₅	111-1231-32	Film resistor (3/4W12KΩ)	2
Q ₄	103-0235-99	Transistor (2SD235LB)	1	R ₁₀₅	111-1221-22	Film resistor (3/8W1.2KΩ)	1
D _{1,2}	001-0112-00	Diode(1S1588)	2	R ₂₀₃	111-1221-32	Film resistor (3/4W1.2KΩ)	1
D ₃	001-0153-00	Diode(1N4004)	1	R ₁₀₁	111-1831-21	Film resistor (3/8W18KΩ)	1
L _{1,3}	009-0470-02	Choke	2	R ₂₀₂	111-2221-32	Film resistor (3/4W2.2KΩ)	1
L ₂	009-0592-01	Choke	1	R _{1,51}	111-2231-32	Film resistor (3/4W22KΩ)	2
L _{4,5}	010-1686-00	Coil	2	R ₁₀₂	111-3331-21	Film resistor (3/8W33KΩ)	1
C ₂₀₄	042-0173-00	Electrolytic capacitor (16V470μF)	1	R _{3,53}	111-3331-32	Film resistor (3/4W33KΩ)	2
C _{5,55}	180-2254-62	Electrolytic capacitor (50V2.2μF)	2	R ₁₀₆	111-3921-21	Film resistor (3/8W3.9KΩ)	1
C _{202, 206}	180-2274-32	Electrolytic capacitor (16V220μF)	2	R ₂₀₁	111-4721-32	Film resistor (3/4W4.7KΩ)	1
C ₂₀₁	180-3364-22	Electrolytic capacitor (10V33μF)	1	R ₁₀₄	111-4731-21	Film resistor (3/8W47KΩ)	1
C _{1,51}	180-4754-32	Electrolytic capacitor (16V4.7μF)	2	R _{4,54}	111-4741-32	Film resistor (3/4W470KΩ)	2
C _{3,53}	180-4764-22	Electrolytic capacitor (10V47μF)	2	R ₁₀₃	111-5631-21	Film resistor (3/8W56KΩ)	1
C ₁₀₁	181-2253-62	Electrolytic capacitor (50V2.2μF)	1	R _{2,52}	111-6831-32	Film resistor (3/4W68KΩ)	2
C _{102, 207}	181-3363-32	Electrolytic capacitor (16V33μF)	2	R _{205, 206, 207}	114-1212-52	Film resistor (1W120Ω)	3
C ₂₀₃	141-1043-15	Polyester capacitor (0.1μF)	1	R ₂₀₄	114-1512-52	Film resistor (1W150Ω)	1
C _{4,54}	141-4722-12	Polyester capacitor (0.0047μF)	2	R ₁₀₈	114-2201-51	Film resistor (1W22Ω)	1
C _{2,52}	153-3302-13	Ceramic capacitor (33PFCH)	2				

©Tape mechanism section



■PARTS LIST:

©Mechanism section

REF.NO.	PART NO. (ORDER NO.)	DESCRIPTION	Q'TY	REF.NO.	PART NO. (ORDER NO.)	DESCRIPTION	Q'TY
1	960-3027-00	Deck plate assembly	1	43	743-2000-10	E-ring	7
2	960-3031-00	Slide plate assembly	1	44	743-1500-10	E-ring	6
3	960-3030-04	Frame assembly	1	45	746-0624-00	Flat washer	2
4	960-3037-00	Cam plate assembly	1	46	330-4896-00	Lead clamp	2
5	960-3029-00	Guide plate assembly	1	47	820-4020-02	Vinyl tube	1
6	960-3043-03	Guide arm assembly	1	48	020-0346-00	Motor assembly	1
7	960-3042-02	Side panel assembly	1	49	602-0041-00	Belt	1
8	960-3045-00	Off plate C assembly	1	50	015-0216-00	Plunger	1
9	960-3046-00	FF idler assembly	1	51	820-4020-04	Vinyl tube	1
10	960-3114-01	Roller B assembly	1	52	630-1016-00	Eject lever	1
11	960-3113-01	Roller A assembly	1	53	345-2651-00	Rubber pad	1
12	960-3032-08	Head plate assembly	1	54	632-0716-00	Eject shaft	1
13	960-3044-00	Arm assembly	1	55	630-1019-00	Hook plate	1
14	960-3038-00	Cam assembly	1	56	013-0018A	Switch assembly	1
15	960-3036-02	Reel base assembly	2	57	606-0062-01	Pack guide	1
16	960-3041-02	Idler plate B assembly	1	58	340-0398-00	Spacer	1
17	960-3040-02	Idler plate A assembly	1	59	631-0234-01	Guide roller	2
18	960-3039-01	Bottom plate assembly	1	60	011-0241-00	Head	1
19	750-1794-00	Eject lever spring	1	61	632-0879-00	Roller	2
20	750-1793-00	Cartridge slot in spring	1	62	631-0231-01	F.F roller	1
21	750-1819-00	Program cam spring	1	63	630-1021-01	Off plate B	1
22	750-1795-01	Pinch roller pressure spring	1	64	630-1020-00	Off plate A	1
23	750-1799-01	Lock off plate spring	1	65	630-1018-01	F.F plate	1
24	750-1797-00	Head plate pressure spring	1	66	632-0789-00	Tention roller	1
25	750-1810-01	F.F idler spring	1	67	632-0791-01	Idler	2
26	630-0931-00	Plate spring	1	68	630-1017-00	Change plate	1
27	630-1001-02	Plate spring B	1	69	631-0224-00	Detector drum	2
28	630-1000-00	Plate spring A	1	70	746-0670-00	Flat washer	1
29	750-1798-00	Cartridge slot down spring	1	71	631-0236-00	Detector	1
30	750-1796-02	Idler pressure spring	1	72	611-0046-00	Flywheel	2
31	750-1811-01	F.F idler guide spring	1	73	631-0222-00	Thrust plate	2
32	714-2603-81	Machine screw (M2.6x3)	10	74	099-4642-03	P.W.B	1
33	714-2605-81	Machine screw (M2.6x5)	3	75	716-0302-00	Special screw	1
34	714-3004-81	Machine screw (M3x4)	2	76	746-0625-00	Flat washer	2
35	820-3030-04	Vinyl tube	1	77	630-1057-00	Plate spring	1
36	714-2004-81	Machine screw (M2x4)	1	78	820-4025-02	Vinyl tube	1
37	714-2605-41	Machine screw (M2.6x5)	1	79	742-3000-20	Toothed washer	1
38	714-2605-81	Machine screw (M2.6x5)	1	80	741-2600-21	Spring washer	2
39	716-0347-00	Sems screw (M2.6x4)	2	81	714-2603-11	Machine screw (M2.6x3)	2
40	716-0286-00	Screw	1	82	746-0621-00	Spring washer	2
41	743-3000-10	E-ring	1	83	744-0001-00	E-ring	1
42	743-2500-10	E-ring	8	84	603-0056-02	Motor pulley	1

PRINTED WIRING BOARD:

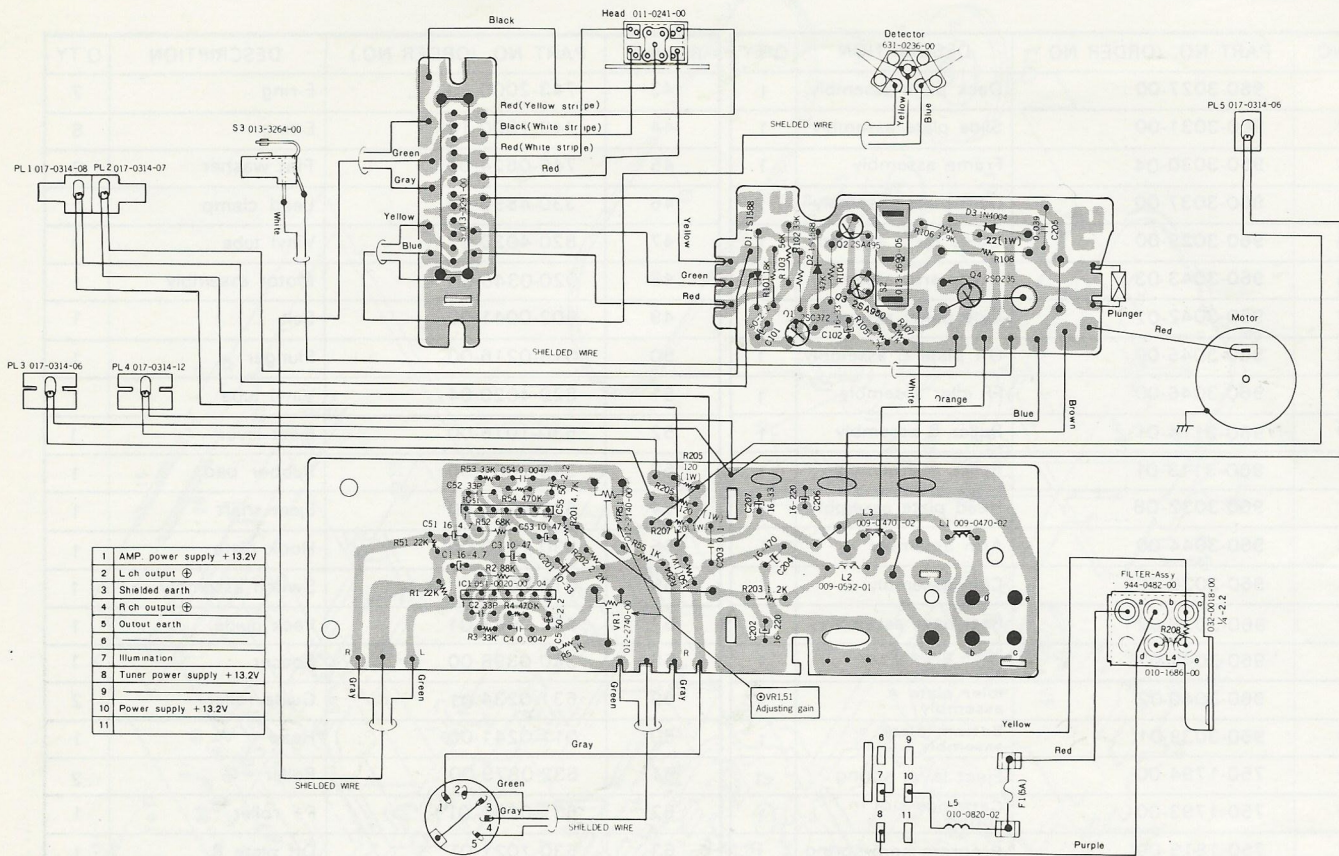

CIRCUIT DIAGRAM:

