

DRWN.	K. Aida
CHKD.	
ENG.	
APP.	

Band Selecting SW(S1 thru S12) are positioned in MW (Broadcast Band)

NT-9P21
 SCHIMATIC DIAGRAM
 YA-12036-1/2 GAP.

PARTNO	NAME OF PART	SPECIFIC NO	RATINGS	QTY EA
TR1	TRANSISTOR		2SA-286	1
TR2	-DITTO-		"	1
TR3	-DO.		2SA-216	1
TR4	DO.		2SA-155	1
TR5	-DO.		"	1
D	DIODE		SD-46	1
L1,2	ANT COIL	YS4-35919		1
L3	-DITTO-	"	"	1
L4	BC RF COIL	"	"	1
L5	SW 1. RF COIL	"	"	1
L6	SW 2. RF COIL	"	"	1
L7	BC OSC COIL	"	"	1
L8	SW 1. OSC COIL	"	"	1
L9	SW 2. OSC COIL	"	"	1
SI-12	BAND SELECT SWITCH	"	"	1
T1	IFT	"	"	1
T2	-DITTO	"	"	1
T3	-DITTO-	"	"	1
C1,2,3	VARI CAP 3 GANGED	"	"	1
C4	MINIATURE V.C	"	"	1
C5,6,7	TRIM CAP 3-SEC	"	"	1
C8-13	TRIM CAP 6-SEC	"	"	1
C14	POLYETHYLEN CAP	"	"	1
C15	-DITTO-	"	"	1
C17	CERAMIC CAP	"	"	1
C18,C16	-DITTO-	"	"	2
C19,21-23	TITANIUM CAP	"	"	4
C20,27	-DITTO-	"	"	2
C24	MYLER CAP	"	"	1
C25	-DITTO-	"	"	1
C26	POLYETHYL CAP	"	"	1
C28,35	ELECTROLYTIC CAP	"	"	2
C29,31	CERAMIC CAP	"	"	2
C30	TITANIUM CAP	"	"	1
C32-34 C36,37,41	MYLER CAP	"	"	6
C38,39	ELECTROLYTIC CAP	"	"	2
C40	MYLER CAP	"	"	1
C42,43	ELECTROLYTIC CAP	"	"	2
C44	CERAMIC CAP	"	"	1
VR	VARI RESW/PWRSW	"	"	1

PARTNO	NAME OF PART	SPECIFIC NO	RATINGS	QTY EA
R1	SOLID CARBON RES	YS4-35375-A	1/8W 56Ω ±5%	1
R2,6,10	-DITTO-	"	"	4
R3,12	DO.	"	"	2
R4,19	DO.	"	"	2
R5	DO.	"	"	1
R7	DO.	"	"	1
R8	DO.	"	"	1
R9,14	-DO.	"	"	2
R13	SOLID CARBON RES	"	"	1
R15	-DITTO-	"	"	1
R17	DO.	"	"	1
R18,20	DO.	"	"	2
R21	DO.	"	"	1
R22	-DO.	"	"	1
SP	LOUDSPEAKER	YS4-20130	9cm 8Ω	1
A	ROD ANTENNA	YS4-60044		1
SW	PUSH BUTTON SW			1
J1,2	EARPHONE JACK	YS4-60087-C		2
B	BATTERIES	YG-20995		3
T	TERMINAL	YI-39794		1

PARTNO	NAME OF PART	SPECIFIC NO	RATINGS	QTY EA
AF UNIT		YU-11646		
TR31	TRANSISTOR		2SB-111	1
TR32	-DITTO-		2SB-112	1
TR33	-DITTO-		2SB-223	1
TR34	-DITTO-		2SB-223	1
TH31,32	THERMISTER		D-32S	2
T31	DRIVER TRANSFORMER	YS4-79-1		1
C301	ELECTROLYTIC CAP	YS4-C3-1-3	3V 10μF	2
C302	-DITTO-	"	"	1
C305	-DITTO-	"	"	2
C306	POLYETHYL CAP	"	"	1
C307	MYLER CAP	"	"	1
R301	SOLID CARBON RES	35375-B	1/8W 120KΩ ±5%	1
R302	-DITTO-	"	"	1
R303	-DO.	"	"	1
R304	-DO.	"	"	1
R305	-DO.	"	"	1
R306	-DO.	"	"	1
R307	-DO.	"	"	1
R308	-DO.	"	"	1
R309	-DO.	"	"	1
R310	-DO.	"	"	2
R311	-DO.	"	"	2
R312	-DO.	"	"	1
R313	-DO.	"	"	1
R314	-DO.	"	"	1
T	TERMINAL	YI-39794	4P	2
PB	PRINTED BOARD	01-34114		1

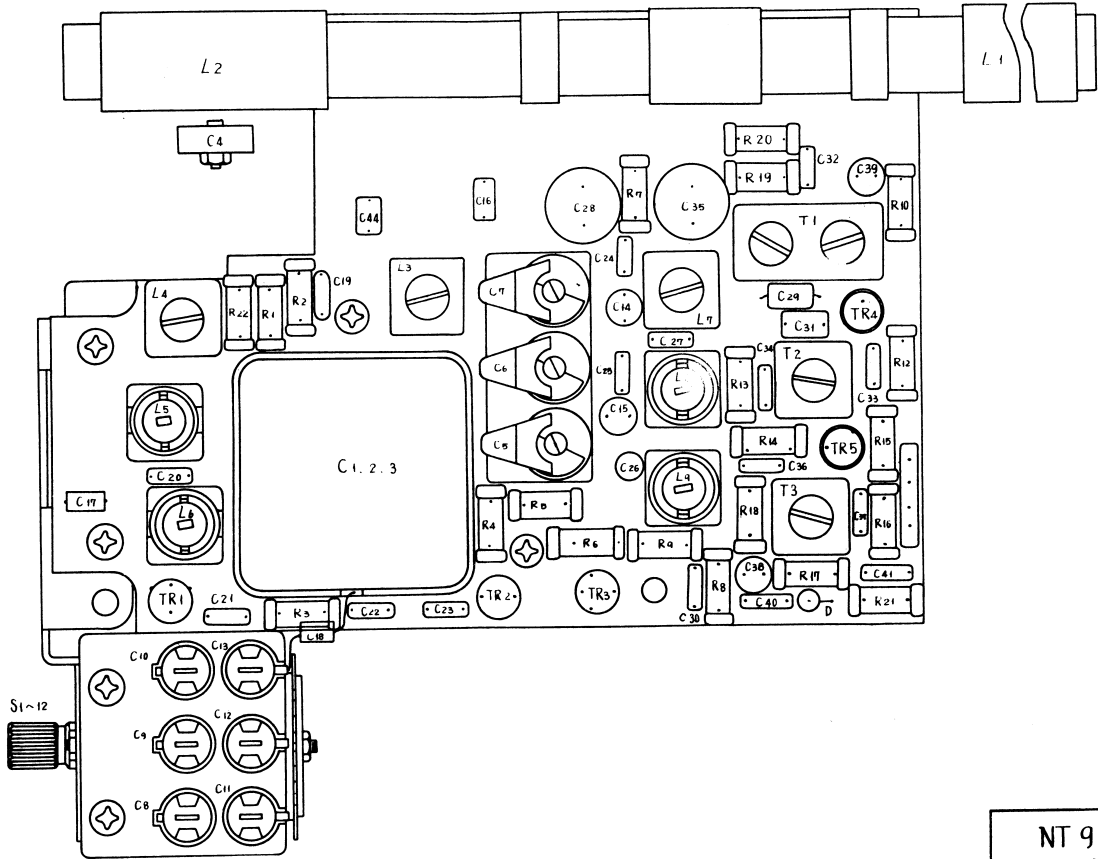

NT 9 P 21
 RF UNIT,
 PRINTED BOARD ASSY
 YA-12037-24^{GRP.}

