

ALPINE SERVICE MANUAL

Exploded View & Parts List For Cassette Deck Mechanism

ADDENDUM & REVISED

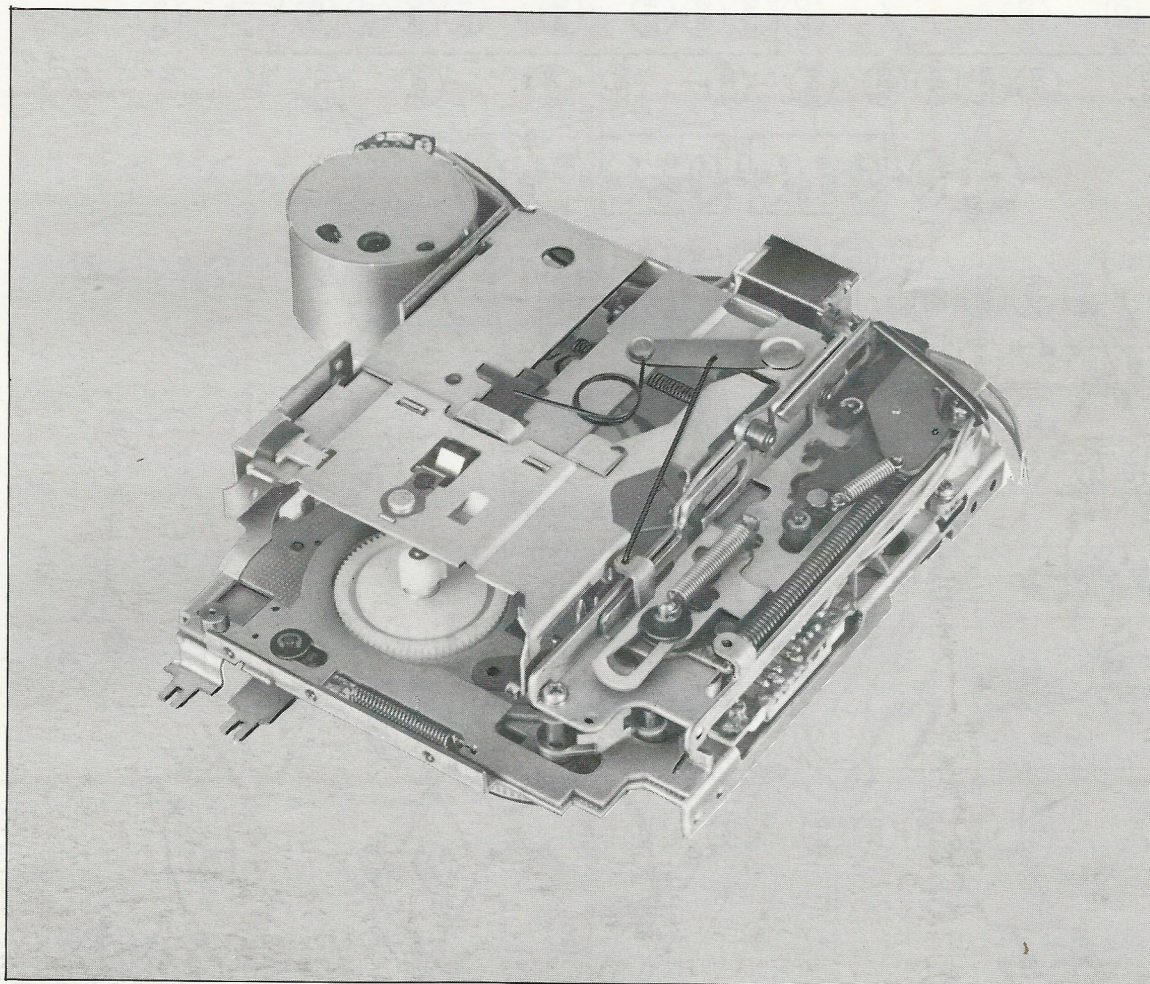

GX SERIES

Contents

(GX75B12B/14E/14L/14P/16D/18L/18M/18P)

Exploded View 3 to 4

Parts List 5 to 7

Replacement of Mechanical Parts 8 to 10

(GX75B36M/38K)

Exploded View 11 to 12

Parts List 13 to 14

Replacement of Mechanical Parts 15 to 17

Exploded View (GX75B12B/14E/14L/14P/16D/18L/18M/18P)

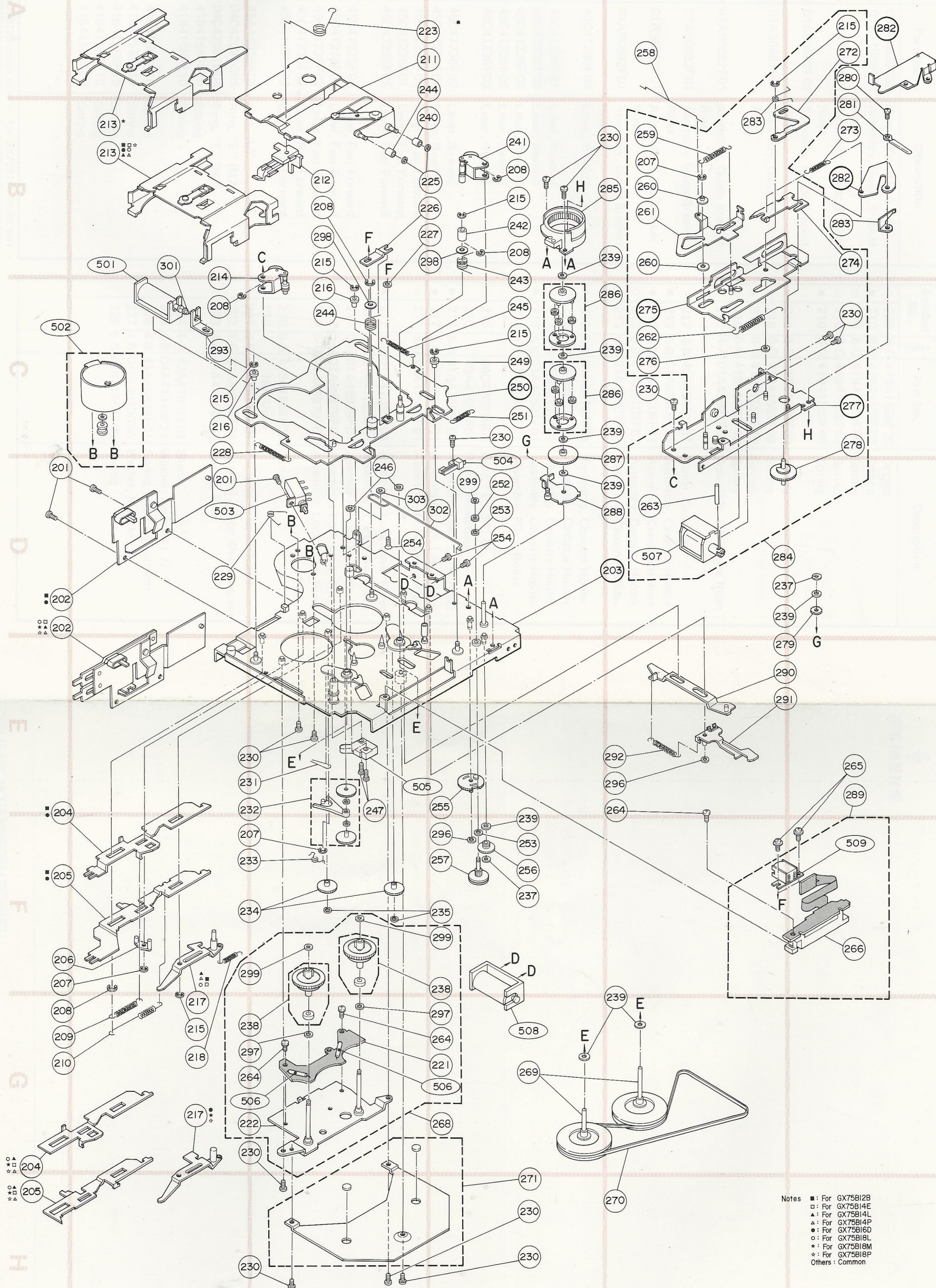

Parts List (GX75B12B/14E/14L/14P/16D/18L/18M/18P)

NOTE: The parts without part number are not supplied.

Symbol No.	Index	Part No.	Description
201		03S44205G30	Screw, Pan (M2.6 x 4)
■ 202	6-D	01A41659F01	Assembly, Guide Bracket Rivet
● 202	6-D	01A41659F01	Assembly, Guide Bracket Rivet
□ 202	6-D	01A56682F01	Assembly, Guide Bracket Rivet
▲ 202	6-D	01A56682F01	Assembly, Guide Bracket Rivet
△ 202	6-D	01A56682F01	Assembly, Guide Bracket Rivet
○ 202	6-D	01A56682F01	Assembly Guide Bracket Rivet
★ 202	6-D	01A56682F01	Assembly Guide Bracket Rivet
☆ 202	6-D	01A56682F01	Assembly, Guide Bracket Rivet
■ 204	6-E	45C41236F04	Lever, Rewind
● 204	6-E	45C41236F01	Lever, Rewind
□ 204	6-G	45C41236F05	Lever, Rewind
▲ 204	6-G	45C41236F05	Lever, Rewind
△ 204	6-G	45C41236F05	Lever, Rewind
○ 204	6-G	45C41236F02	Lever, Rweind
★ 204	6-G	45C41236F02	Lever, Rewind
☆ 204	6-G	45C41236F02	Lever, Rewind
■ 205	6-F	45C41235F04	Lever, Fast Forward
● 205	6-F	45C41235F01	Lever, Fast Forward
□ 205	6-H	45C41235F05	Lever, Fast Forward
▲ 205	6-H	45C41235F05	Lever, Fast Forward
△ 205	6-H	45C41235F05	Lever, Fast Forward
○ 205	6-H	45C41235F02	Lever, Fast Forward
★ 205	6-H	45C41235F02	Lever, Fast Forward
☆ 205	6-H	45C41235F02	Lever, Fast Forward
206	6-F	45A45326F01	Link, R/F
207		04C42091G05	Ring, "E" (M2)
208		04C42091G04	Ring, "E" (M3)
■ 209	6-G	41B41559F10	Spring
□ 209	6-G	41B41559F10	Spring
△ 209	6-G	41B41559F10	Spring
● 209	6-G	41B41559F10	Spring
★ 209	6-G	41B41559F10	Spring
☆ 209	6-G	41B41559F10	Spring
▲ 209	6-G	41B41559F20	Spring

Symbol No.	Index	Part No.	Description
○ 209	6-G	41B41559F20	Spring
■ 210	6-G	41B41559F09	Spring
□ 210	6-G	41B41559F09	Spring
△ 210	6-G	41B41559F09	Spring
● 210	6-G	41B41559F09	Spring
★ 210	6-G	41B41559F09	Spring
☆ 210	6-G	41B41559F09	Spring
▲ 210	6-G	41B41559F19	Spring
○ 210	6-G	41B41559F19	Spring
211	4-A	01A45981F01	Assembly, Idler Plate Rivet
212	4-B	45B45858F01	Guide, Cassette
■ 213	5-B	01A69106F01	Assembly, Cassette Holder
● 213	5-B	01A69106F01	Assembly, Cassette Holder
□ 213	5-B	01A69107F01	Assembly, Cassette Holder
▲ 213	5-B	01A69107F01	Assembly, Cassette Holder
△ 213	5-B	01A69107F01	Assembly, Cassette Holder
○ 213	5-B	01A69107F01	Assembly, Cassette Holder
☆ 213	5-B	01A69107F01	Assembly, Cassette Holder
★ 213	5-B	01A44507F01	Assembly, Cassette Holder
214	5-C	01T51012F01	Assembly, Pinch Roller
215		04C42091G06	Ring, "E" (M1.5)
216		49A41005F01	Roller, Head Base
■ 217	5-G	01A47085F01	Assembly, Lock Lever Rivet
● 217	5-G	01A45979F01	Assembly, Lock Lever Rivet
□ 217	5-G	01A47085F01	Assembly, Lock Lever Rivet
▲ 217	5-G	01A47085F01	Assembly, Lock Lever Rivet
△ 217	5-G	01A47085F01	Assembly, Lock Lever Rivet
★ 217	5-G	01A45979F01	Assembly, Lock Lever Rivet
☆ 217	5-G	01A45979F01	Assembly, Lock Lever Rivet
○ 217	5-G	01A45979F02	Assembly, Lock Lever Rivet
218	5-G	41B41559F08	Spring
219		Not Used	
221	4-G	84A69210F01	P.C. Board, Reed Switch
222	5-G	01A41656F01	Assembly, Reel Shaft Bracket
223	4-A	41A41590F03	Spring, Turn
224	4-A	43A41072F03	Spacer
225	4-B	04A41345P21	Washer, Lock (M1.7)
226	4-B	41A45638F01	Spring, Head Adjustment
227	4-B	04S40070G56	Washer, Flat (M2.1)
228	5-C	41B41559F05	Spring

Notes: ■ : For GX75B12B model only, □ : For GX75B14E model only,
 ▲ : For GX75B14L model only, △ : For GX75B14P model only,
 ● : For GX75B16D model only, ○ : For GX75B18L model only,
 ★ : For GX75B18M model only, ☆ : For GX75B18P model only,
 Others : Common

NOTE: The parts without part number are not supplied.

Symbol No.	Index	Part No.	Description
229	5-D	41A43244F01	Spring, B.T.
230		03D40014G12	Screw, W/Washer (M2.6 x 4)
231	5-E	41A41393F01	Spring, R/F Idler Arm
232	5-E	01C41353F01	Assembly, R/F Idler
233	5-F	41A42613F01	Spring, R/F Idler
234	5-F	44A41406F01	Gear, Take-up
235	4-F	04A41345P01	Washer, Lock (M1.2)
236		Not Used	
237		04A41345P02	Wasehr, Lock (M1.7)
238		01V71800F76	Assembly, Reel Magnet
239		04S40075G06	Washer, Polyslider (M2.1)
240	4-B	43A41072F02	Spacer
241	3-B	01T51011F01	Assembly, Pinch Roller
242	3-B	43A41079F01	Spacer
243	3-C	41A41453F01	Spring, Pinch Roller
244	4-C	41A41453F02	Spring, Pinch Roller
245	3-C	41B41559F04	Spring
246	4-D	43A44303P03	Washer, Oil Shield (M1.9)
● 247	4-E	03S68259F16	Screw, Pan (M2 x 6.5)
○ 247	4-E	03S68259F16	Screw, Pan (M2 x 6.5)
★ 247	4-E	03S68259F16	Screw, Pan (M2 x 6.5)
☆ 247	4-E	03S68259F16	Screw, Pan (M2 x 6.5)
248		Not Used	
249	3-C	49A43395F01	Roller, Head Base
■ 251	3-C	41C45984F09	Spring
□ 251	3-C	41C45984F09	Spring
△ 251	3-C	41C45984F09	Spring
● 251	3-C	41C45984F09	Spring
★ 251	3-C	41C45984F09	Spring
☆ 251	3-C	41C45984F09	Spring
▲ 251	3-C	41C45984F18	Spring
○ 251	3-C	41C45984F18	Spring
252	3-D	44A41349F01	Gear, Pulley
253		04S40075G09	Washer, Polyslider (M2.6)
254		03S56479F05	Screw, Countersunk (M2 x 4)
255	4-E	44A61571F01	Gear, Change
256	3-F	44A41350F01	Gear, Reverse Idler
■ 257	4-F	44A41351F01	Gear, Pulley Wheel
● 257	4-F	44A41351F02	Gear, Pulley Wheel
□ 257	4-F	44A41351F01	Gear, Pulley Wheel
△ 257	4-F	44A41351F01	Gear, Pulley Wheel
★ 257	4-F	44A41351F01	Gear, Pulley Wheel
☆ 257	4-F	44A41351F01	Gear, Pulley Wheel
▲ 257	4-F	44A41351F03	Gear, Pulley Wheel
○ 257	4-F	44A41351F03	Gear, Pulley Wheel

Symbol No.	Index	Part No.	Description
258	2-A	45A41392F01	Link, Connection
259	2-B	41B41559F12	Spring
260		43A42872F01	Spacer
261	2-B	45B41068F01	Lever, Sub
262	2-C	41B41559F13	Spring
263	2-D	22B40232G06	Pin, Spring
264		03S43997P62	Screw, Round (M2.6 x 3)
265	1-E	03S40019G03	Screw, F-Lock (M2 x 4)
266	1-F	01V00100S14	Assembly, Switch P.C. Board (Include Slide Switch)
267		Not Used	
268	4-G	01V71100F30	Assembly, Reel Bracket
269	3-G	01T42014F01	Assembly, Flywheel
270	3-H	42A40969F01	Belt
271	3-H	01V41500F39	Assembly, Flywheel Bracket
■ 272	1-A	45A41042F02	Lever, Lock Eject
▲ 272	1-A	45A41042F02	Lever, Lock Eject
● 272	1-A	45A41042F02	Lever, Lock Eject
○ 272	1-A	45A41042F02	Lever, Lock Eject
☆ 272	1-A	45A41042F02	Lever, Lock Eject
□ 272	1-A	45A41042F01	Lever, Lock Eject
△ 272	1-A	45A41042F01	Lever, Lock Eject
★ 272	1-A	45A41042F01	Lever, Lock Eject
273	1-B	41B41559F03	Spring
274	1-B	64A45857F01	Plate, Head Lock
276	2-C	43A41072F04	Spacer
278	1-C	01T45861F01	Assembly, Eject Gear
279	2-E	44A41348F01	Gear, Eject Idler
280	1-A	03S56479F01	Screw, W/Washer (M2.6 x 10)
281	1-B	29A737272	Lug, Wrap Around
■ 283		41A61919F01	Spring, Solenoid
□ 283		41A61919F01	Spring, Solenoid
● 283		41A61919F01	Spring, Solenoid
▲ 283		41A68489F01	Spring, Solenoid
△ 283		41A68489F01	Spring, Solenoid
○ 283		41A68489F01	Spring, Solenoid
☆ 283		41A68489F01	Spring, Solenoid
★ 283		41A41390F01	Spring, Solenoid
■ 284	2-D	01V66500F85	Assembly, Eject Lever
● 284	2-D	01V66500F85	Assembly, Eject Lever
□ 284	2-D	01V45700F66	Assembly, Eject Lever
★ 284	2-D	01V45700F66	Assembly, Eject Lever
▲ 284	2-D	01V69100F52	Assembly, Eject Lever
○ 284	2-D	01V69100F52	Assembly, Eject Lever
△ 284	2-D	01V69100F41	Assembly, Eject Lever
☆ 284	2-D	01V69100F41	Assembly, Eject Lever

Notes: ■ : For GX75B12B model only, □ : For GX75B14E model only,
 ▲ : For GX75B14L model only, △ : For GX75B14P model only,
 ● : For GX75B16D model only, ○ : For GX75B18L model only,
 ★ : For GX75B18M model only, ☆ : For GX75B18P model only,
 Others : Common

Note: The parts without part number are not supplied.

Symbol No.	Index	Part No.	Description
285	3-B	44B41260F01	Gear, Fixed
286		01V41500F30	Assembly, Planet Gear
287	3-C	44A41354F01	Gear, Guide
288	3-D	01A50669F01	Assembly, Rivet Lever Idler
■ 289	1-E	01V53500F49	Assembly, Head/Switch
● 289	1-E	01V53500F49	Assembly, Head/Switch
□ 289	1-E	01V56800F82	Assembly, Head/Switch
▲ 289	1-E	01V56800F82	Assembly, Head/Switch
○ 289	1-E	01V56800F82	Assembly, Head/Switch
★ 289	1-E	01V56800F82	Assembly, Head/Switch
△ 289	1-E	01V68600F38	Assembly, Head/Switch
☆ 289	1-E	01V74900F09	Assembly, Head/Switch
290	2-E	01A41661F01	Assembly, Release Lever
291	2-E	45C45545F01	Lever, Reverse
292	3-E	41C45984F01	Spring
■ 293	5-C	45A45618F01	Lever, Mute Solenoid
□ 293	5-C	45A45618F01	Lever, Mute Solenoid
▲ 293	5-C	45A45618F01	Lever, Mute Solenoid
△ 293	5-C	45A45618F01	Lever, Mute Solenoid
● 293	5-C	45A45618F01	Lever, Mute Solenoid
□ 294		Not Used	
295		Not Used	
296		04A41345P08	Washer, Lock (M1.7)
297		04S40075G52	Washer, Polyslider (M2.2)
298		04A66841F01	Spacer, Spring Pinch
299		04A41345P12	Washer, Lock (M1.7)
□ 301	5-B	41A67004F01	Spring, Sensor Solenoid
▲ 301	5-B	41A67004F01	Spring, Sensor Solenoid
△ 301	5-B	41A67004F01	Spring, Sensor Solenoid
▲ 302	4-D	41A68551F01	Link, Release
○ 302	4-D	41A68551F01	Link, Release
○ 303	4-D	04A41345P19	Washer, Lock (M1.7)
Miscellaneous Parts			
■ 501	5-B	01T66519F01	Assembly, Sensor Solenoid
□ 501	5-B	01T66519F01	Assembly, Sensor Solenoid
▲ 501	5-B	01T66519F01	Assembly, Sensor Solenoid
△ 501	5-B	01T66519F01	Assembly, Sensor Solenoid
■ 502	6-C	01V69400F79	Assembly, Motor

Symbol No.	Index	Part No.	Description
● 502	6-C	01V69400F79	Assembly, Motor
□ 502	6-C	01V61500F28	Assembly, Motor
▲ 502	6-C	01V61500F28	Assembly, Motor
△ 502	6-C	01V61500F28	Assembly, Motor
○ 502	6-C	01V61500F28	Assembly, Motor
★ 502	6-C	01V61500F28	Assembly, Motor
☆ 502	6-C	01V61500F28	Assembly, Motor
■ 503	5-D	40T43144U03	Switch, Push (FF/REW-PLAY)
□ 503	5-D	40T43144U03	Switch, Push (FF/REW-PLAY)
▲ 503	5-D	40T43144U03	Switch, Push (FF/REW-PLAY)
△ 503	5-D	40T43144U03	Switch, Push (FF/REW-PLAY)
504	3-D	40T43662U01	Switch, Leaf
● 505	4-E	40T41665F01	Switch, Slide (FF/REW-PLAY)
○ 505	4-E	40T41665F01	Switch, Slide (FF/REW-PLAY)
★ 505	4-E	40T41665F01	Switch, Slide (FF/REW-PLAY)
☆ 505	4-E	40T41665F01	Switch, Slide (FF/REW-PLAY)
506		40T40641U02	Switch, Reed
■ 507	2-D	01T66517F01	Assembly, Keep Solenoid
□ 507	2-D	01T66517F01	Assembly, Keep Solenoid
▲ 507	2-D	01T66517F01	Assembly, Keep Solenoid
● 507	2-D	01T66517F01	Assembly, Keep Solenoid
○ 507	2-D	01T66517F01	Assembly, Keep Solenoid
★ 507	2-D	01T66517F04	Assembly, Keep Solenoid
△ 507	2-D	01T66517F04	Assembly, Keep Solenoid
☆ 507	2-D	01T66517F04	Assembly, Keep Solenoid
508	3-G	01T66518F01	Assembly, Program Solenoid
■ 509	1-E	88T45248F01	Head, Playback
● 509	1-F	88T45248F01	Head, Playback
□ 509	1-F	88T50977F01	Head, Playback
▲ 509	1-F	88T50977F01	Head, Playback
○ 509	1-F	88T50977F01	Head, Playback
★ 509	1-F	88T50977F01	Head, Playback
△ 509	1-F	88T74470F01	Head, Playback
☆ 509	1-F	88T74470F01	Head, Playback

Notes: ■ : For GX75B12B model only, □ : For GX75B14E model only,
 ▲ : For GX75B14L model only, △ : For GX75B14P model only,
 ● : For GX75B16D model only, ○ : For GX75B18L model only,
 ★ : For GX75B18M model only, ☆ : For GX75B18P model only,
 Others : Common

Replacement of Mechanical Parts (GX75B12B/14E/14L/14P/16D/18L/18M/18P)

1. Removal of Cassette Deck

- (1) Remove the cassette deck according to the item on "Parts Location and Disassembly Instructions".

2. Removal of Eject Lever Assembly

- (1) Remove two screws marked "○" as shown in Figure 1.
- (2) The eject lever assembly can be removed.

3. Removal of Deck Cover

- (1) Remove one screw marked "※" as shown in Figure 2.

4. Replacement of Keep Solenoid Assembly

- (1) Remove two screws marked "X" as shown in Figure 1 and the keep solenoid can be removed. (Plunger can not be removed.)
- (2) After replacing the keep solenoid with a new one, install it in the opposite way to disassembly and adjust the mounting position of the eject lock lever as shown in Figure 4.

5. Replacement of Sensor Solenoid Assembly (GX75B12B/14E/L/P only)

- (1) Remove one screw marked "★" as shown in Figure 2 and the sensor solenoid can be removed.
- (2) After replacing the sensor solenoid with a new one, install it in the opposite way to disassembly.

6. Replacement of Pinch Roller Assembly (L)

- (1) Remove the eject lever assembly.
- (2) Remove the pinch roller spring and two "E" rings and one washer to remove the pinch roller assembly as shown in Figure 3.
- (3) After replacing the pinch roller assembly with a new one, clean the pinch roller with absolute alcohol and assemble it in the opposite way to disassembly.
- (4) After assembling, confirm the tape speed and the wow/flutter with the fast tape (MTT-111).
- (5) The pinch roller assembly (R) can also be removed in same way.

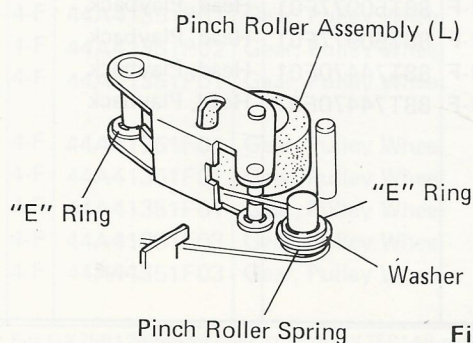

Figure 3

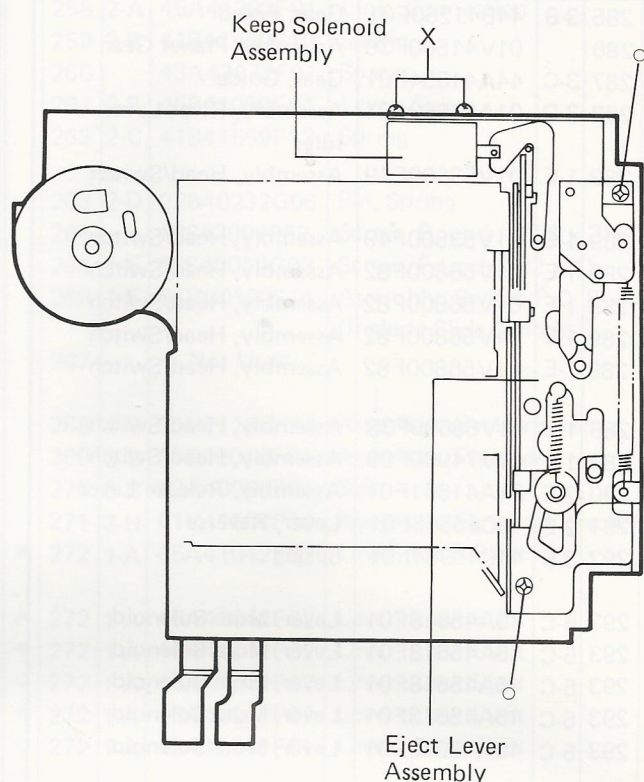

Figure 1

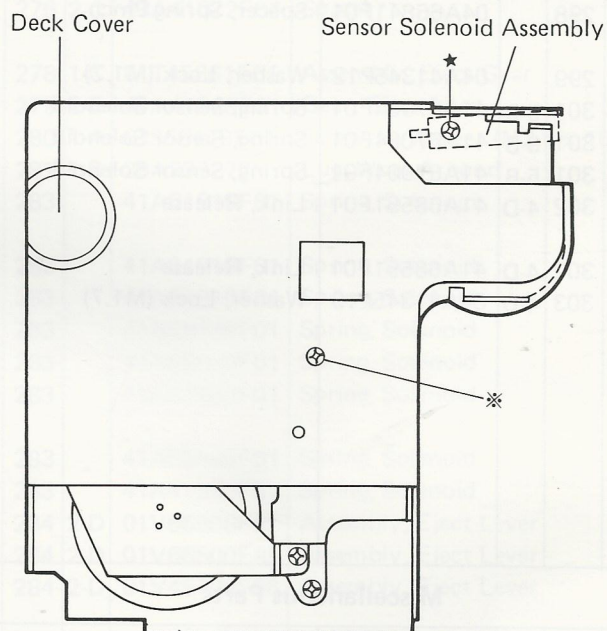

Figure 2

7. Replacement of Head

- (1) Remove the eject lever assembly.
- (2) Unsolder one screw marked "△" and then remove it and two screws marked "□" as shown in Figure 6.
- (3) Remove the head from the P.C. Board.
- (4) After replacing the head with a new one, hold the head and switch P.C. Board with three screws temporarily and assemble them in the opposite way to disassembly.
- (5) After assembly, adjust the position of the head and switch P.C. Board so that the clearances on the both ends of the slide switch become equal on the side or normal and reverse as shown in Figure 5.
- (6) After adjusting, solder one screw marked "△" as shown in Figure 6.
- (7) Finally, adjust the head azimuth according to "Head Azimuth Adjustment", and apply the screw-lock paint on the adjusting screw.

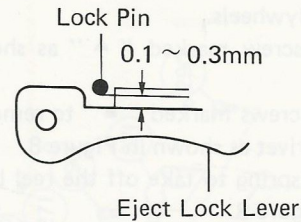

Figure 4

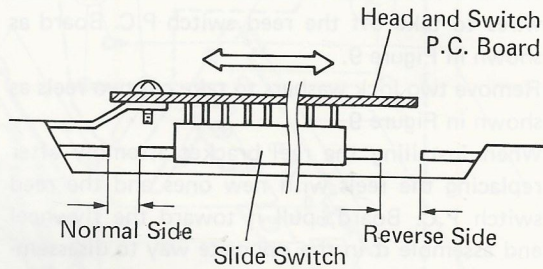

Figure 5

8. Replacement of Motor

- (1) Remove two screws marked "●" as shown in Figure 7.
- (2) Remove a lead wire from the motor side to remove the motor.
- (3) After replacing the motor with a new one, assemble it in the opposite way to disassembly.
- (4) After assembling, confirm the tape speed and the wow/flutter with the test tape (MTT-111).

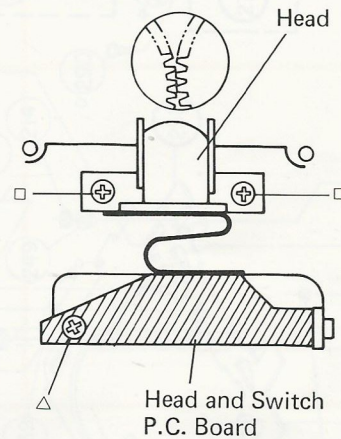

Figure 6

9. Replacement of Program Solenoid

- (1) Remove two screws marked "○" as shown in Figure 7 to remove the program solenoid.
- (2) After replacing the program solenoid with a new one, assemble in it the opposite way to disassembly.

10. Replacement of Belt and Flywheel

- (1) Remove three screws marked "#" and the flywheel bracket as shown in Figure 7 to take off the belt and the flywheel.

NOTE: The washers as shown in Figure 8 are taken off together with the flywheel, be sure not to lose them.

- (2) After replacing the belt and the flywheel with new ones, clean them with absolute alcohol and assemble them in the opposite way to disassembly.
- (3) After assembling, confirm the tape speed and the wow/flutter with the test tape (MTT-111).

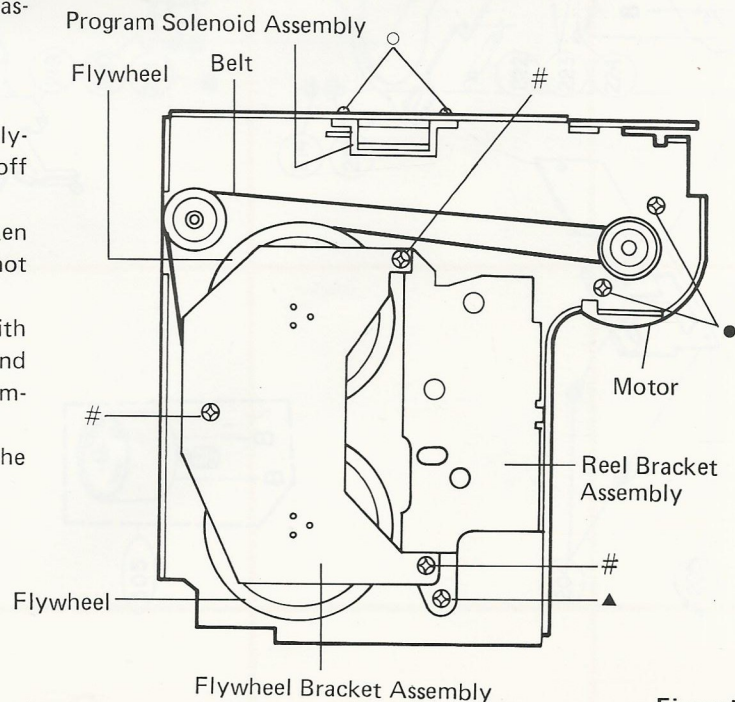

Figure 7

11. Replacement of Reed Switch and Reels

- (1) Remove two flywheels.
- (2) Remove one screw marked "▲" as shown in Figure 7.
- (3) Remove two screws marked "■" to remove the guide bracket rivet as shown in Figure 8.
- (4) Remove B.T. spring to take off the reel bracket as shown in Figure 8.
- (5) Remove two screws marked "☆" and the lead wires to take off the reed switch P.C. Board as shown in Figure 9.
- (6) Remove two lock washers to take off two reels as shown in Figure 9.
- (7) When installing the reel bracket assembly after replacing the reels with new ones and the reed switch P.C. Board, pull it toward the flywheel and assemble it in the opposite way to disassembly.
- (8) After assembling, confirm the tape speed and the wow/flutter with the test tape (MTT-111).

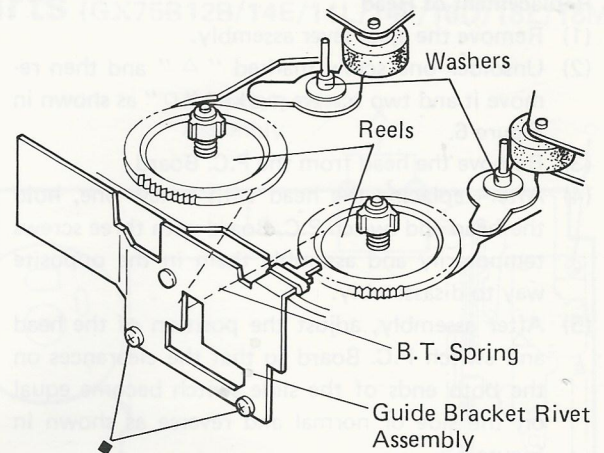

Figure 8

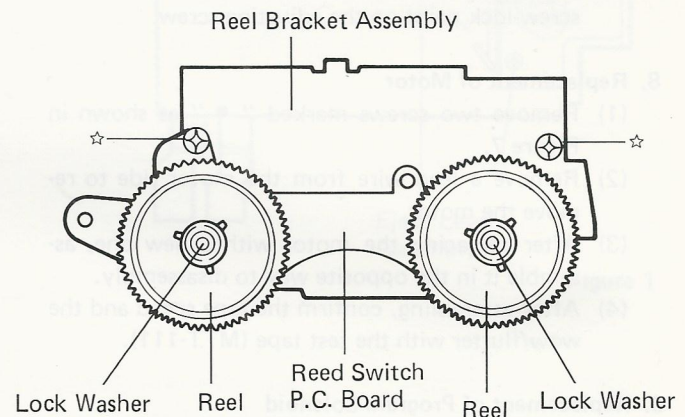
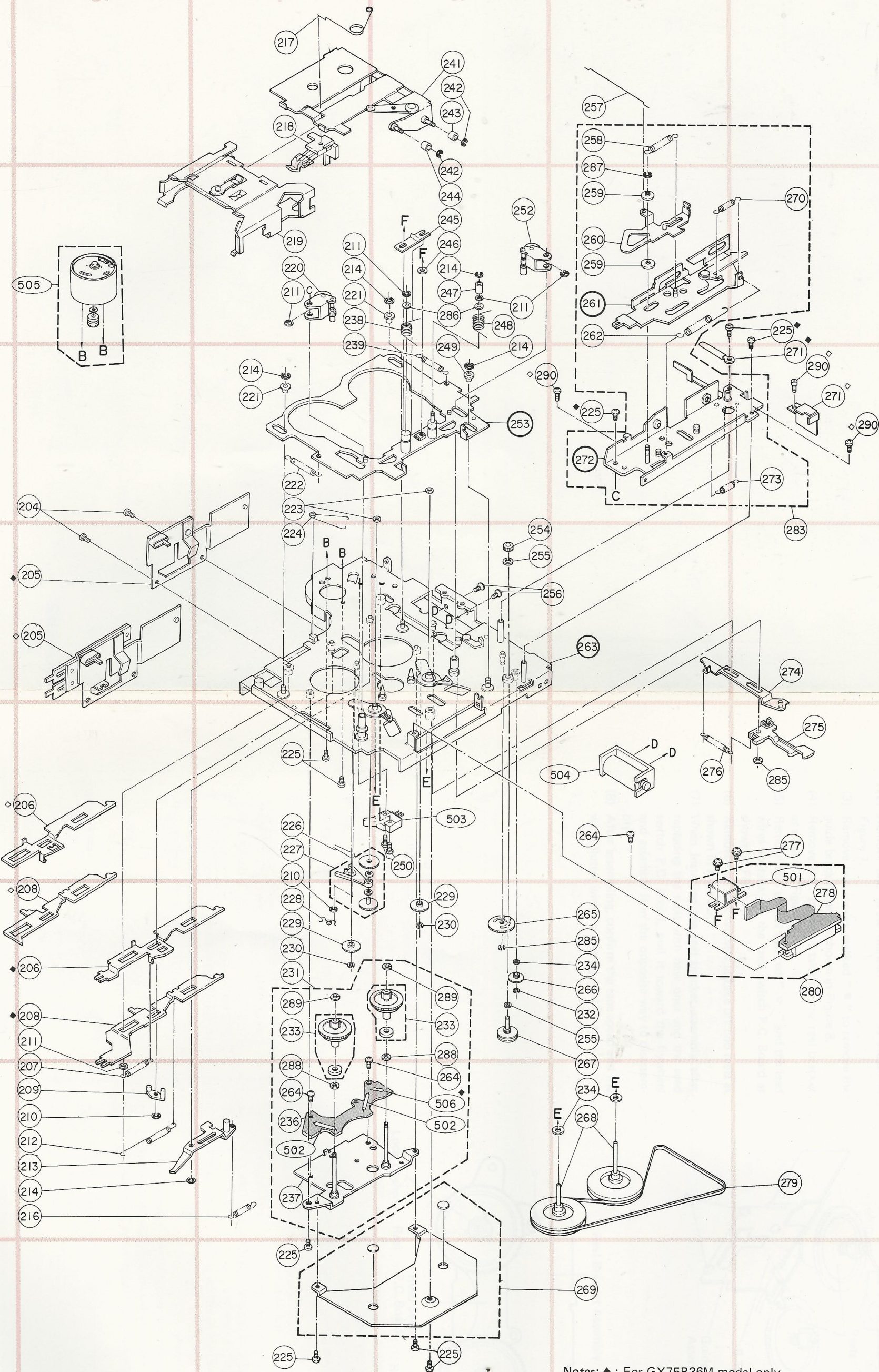

Figure 9



Notes: ◆ : For GX75B36M model only
 ◻ : For GX75B38K model only
 Others : Common

Parts List (GX75B36M/38K)

Symbol No.	Index	Part No.	Description
◆ 204	6-C	03S44205G30	Screw, Pan (M2.6 x 4)
◆ 205	6-D	01A41659F01	Assembly, Guide Bracket Rivet
◇ 205	6-D	01A56682F01	Assembly, Guide Bracket Rivet
◆ 206	6-F	45C41236F01	Lever, Rewind
◇ 206	6-E	45C41236F02	Lever, Rewind
207	6-G	41B41559F10	Spring
◆ 208	6-F	45C41235F01	Lever, Fast Forward
◇ 208	6-F	45C41235F02	Lever, Fast Forward
209	6-G	45A45326F01	Link, R/F
210		04C42091G05	Ring, "E" (M2)
211		04C42091G04	Ring, "E" (M3)
212	6-G	41B41559F09	Spring
213	6-G	01A45979F01	Assembly, Lock Lever Rivet
214		04C42091G06	Ring, "E" (M1.5)
216	6-G	41B41559F08	Spring
217	4-A	41A41590F03	Spring, Turn
218	4-A	45B45858F01	Guide, Cassette
◆ 219	4-B	01A69106F01	Assembly, Cassette Holder
◇ 219	4-B	01A69107F01	Assembly, Cassette Holder
220	4-B	01T51012F01	Assembly, Pinch Roller (L)
221		49A41005F01	Roller, Head Base
222	4-C	41B41559F05	Spring
223	4-C	43A44303F03	Washer, Oil Shield (M1.9)
224	4-D	41A43244F01	Spring, B.T.
225		03D40014G12	Screw, W/Washer (M2.6 x 4)
226	4-E	41A41393F01	Spring, R/F Idler Arm
227	4-E	01C41353F01	Gear, R/F Idler
228	4-F	41A42613F01	Spring, R/F Idler
229		44A41406F01	Gear, Take-Up
230		04A41345P01	Washer, Lock (M1.2)
◆ 231	4-F	01V71100F33	Assembly, Reel Bracket
◇ 231	4-F	01V71100F30	Assembly, Reel Bracket
232	2-F	04A41345P02	Washer, Lock (M1.7)
◆ 233		01V41500F38	Assembly, Reel Magnet
◇ 233		01V71800F76	Assembly, Reel Magnet
234		04S40075G06	Washer, Polyslider (M2.1)
236	4-G	84A69210F01	P.C. Board, Reed Switch
237	4-G	01A41656F01	Assembly, Reel Shaft Bracket
238	4-B	41A41453F02	Spring, Pinch Roller
239	4-B	41B41559F04	Spring

NOTE: The parts without part number are not supplied.

Symbol No.	Index	Part No.	Description
241	3-A	01A45981F01	Assembly, Idler Plate Rivet
242		04A41345P21	Washer, Lock (M1.7)
243	3-A	43A41072F02	Spacer
244	3-B	43A41072F03	Spacer
245	3-B	41A45638F01	Spring, Head Adjustment
246	3-B	04S40070G56	Washer, Flat (M2.1)
247	3-B	43A41079F01	Spacer
248	3-B	41A41453F01	Spring, Pinch Roller
249	3-B	49A43395F01	Roller, Head Base
250	3-E	03S68259F16	Screw, Pan (M2 x 6.5)
252	3-B	01T51011F01	Assembly, Pinch Roller (R)
254	3-D	44A41349F01	Gear, Pulley
255		04S40075G09	Washer, Polyslider (M2.6)
256	3-D	03S56479F05	Screw, Countersunk (M2 x 4)
257	2-A	45A41392F01	Link, Connection
258	2-A	41B41559F12	Spring
259		43A42872F01	Spacer
260	2-B	45B41068F01	Lever, Sub
262	2-B	41C45984F03	Spring
264		03S43997P62	Screw, Round (M2.6 x 3)
265	2-F	44A61571F01	Gear, Change
266	2-F	44A41350F01	Gear, Reverse Idler
267	2-F	44A41351F01	Gear, Wheel Pulley
268	2-G	01T42014F01	Assembly, Flywheel
269	2-H	01V41500F39	Assembly, Flywheel Bracket
270	1-B	41B41559F06	Spring
◆ 271	1-C	29A737272	Lug, Wrap Around
◇ 271	1-C	07A69336F01	Bracket, Wire
273	1-C	41C45984F02	Spring
274	1-D	01A41661F01	Assembly, Release Lever
275	1-E	45B61648F01	Lever, Reverse
276	2-E	41C45984F01	Spring
277	1-E	03S40019G03	Screw, F-Lock (M2 x 4)
278	1-F	01V00100S14	Assembly, Switch P.C. Board
279	1-G	42A40969F01	Belt
280	1-F	01V56800F82	Assembly, Head & Switch
283	1-C	01V45700F72	Assembly, Eject Lever
285		04A41345P08	Washer, Lock (M1.7)
286	3-B	04A66841F01	Spacer, Pinch Roller Spring
287	2-B	04C42091G11	Ring, "E" (M2.5)
288		04S40075G52	Washer, Polyslider (M2.2)
289		04A41345P12	Washer, Lock (M1.7)
◇ 290		03D40014G06	Screw, W/Washer (M2.6 x 5)

Notes: ◆ : For GX75B36M model only

◇ : For GX75B38K model only

Others : Common

NOTE: The parts without part number are not supplied.

Symbol No.	Index	Part No.	Description
Miscellaneous Parts			
501	1-E	88T50977F01	Head, Playback
502		40T40641U02	Switch, Reed
503	3-E	40T41665F01	Switch, Slide
504	3-E	01T66518F01	Assembly, Program Solenoid
505	5-B	01V61500F28	Assembly, Motor
◆ 506	3-G	06S55429F16	Resistor, Carbon Film 120K ohm, 1/6W

[illegible]

Notes: ♦ : For GX75B36M model only

◇ : For GX75B38K model only

Others : Common

Replacement of Mechanical Parts (GX75B36M/38K)

1. Removal of Cassette Deck

- (1) Remove the cassette deck according to the item on "Parts Location and Disassembly Instructions".

2. Removal of Eject Lever Assembly

- (1) Remove three screws marked "○" as shown in Figure 1.
- (2) The eject lever assembly can be removed.

3. Removal of Deck Cover

- (1) Remove one screw marked "※" as shown in Figure 2.

4. Replacement of Pinch Roller Assembly (L)

- (1) Remove the eject lever assembly.
- (2) Remove the pinch roller spring and two "E" rings and one washer to remove the pinch roller assembly as shown in Figure 3.
- (3) After replacing the pinch roller assembly with a new one, clean the pinch roller with absolute alcohol and assemble it in the opposite way to disassembly.
- (4) After assembling, confirm the tape speed and the wow/flutter with the fast tape (MTT-111).
- (5) The pinch roller assembly (R) can also be removed in same way.

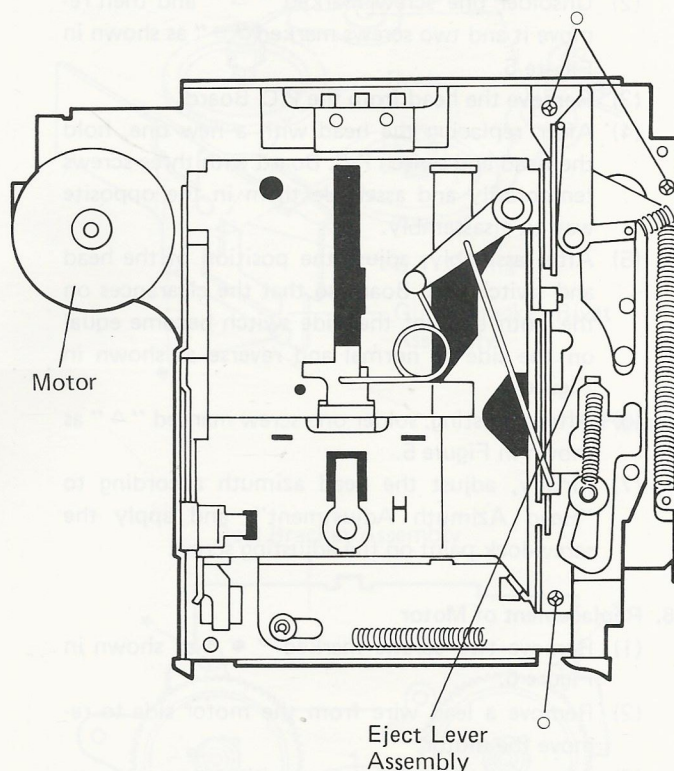

Figure 1

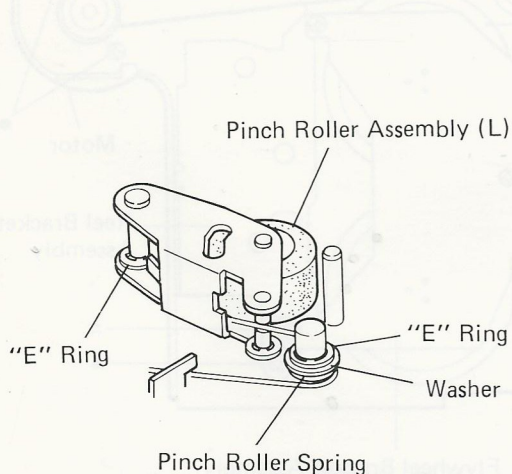

Figure 3

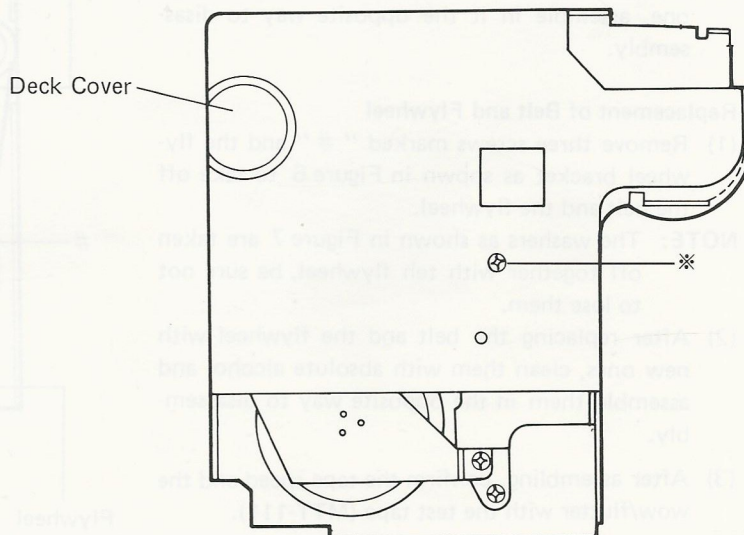

Figure 2

5. Replacement of Head

- (1) Remove the eject lever assembly.
- (2) Unsolder one screw marked "△" and then remove it and two screws marked "□" as shown in Figure 5.
- (3) Remove the head from the P.C. Board.
- (4) After replacing the head with a new one, hold the head and switch P.C. Board with three screws temporarily and assemble them in the opposite way to disassembly.
- (5) After assembly, adjust the position of the head and switch P.C. Board so that the clearances on the both ends of the slide switch become equal on the side or normal and reverse as shown in Figure 4.
- (6) After adjusting, solder one screw marked "△" as shown in Figure 5.
- (7) Finally, adjust the head azimuth according to "Head Azimuth Adjustment", and apply the screw-lock paint on the adjusting screw.

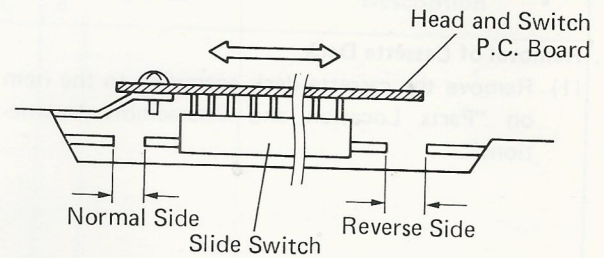

Figure 4

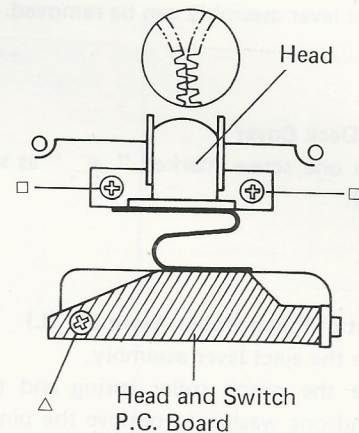

Figure 5

6. Replacement of Motor

- (1) Remove two screws marked "●" as shown in Figure 6.
- (2) Remove a lead wire from the motor side to remove the motor.
- (3) After replacing the motor with a new one, assemble it in the opposite way to disassembly.
- (4) After assembling, confirm the tape speed and the wow/flutter with the test tape (MTT-111).

7. Replacement of Program Solenoid

- (1) Remove two screws marked "○" as shown in Figure 6 to remove the program solenoid.
- (2) After replacing the program solenoid with a new one, assemble in it the opposite way to disassembly.

8. Replacement of Belt and Flywheel

- (1) Remove three screws marked "#" and the flywheel bracket as shown in Figure 6 to take off the belt and the flywheel.

NOTE: The washers as shown in Figure 7 are taken off together with the flywheel, be sure not to lose them.

- (2) After replacing the belt and the flywheel with new ones, clean them with absolute alcohol and assemble them in the opposite way to disassembly.
- (3) After assembling, confirm the tape speed and the wow/flutter with the test tape (MTT-111).

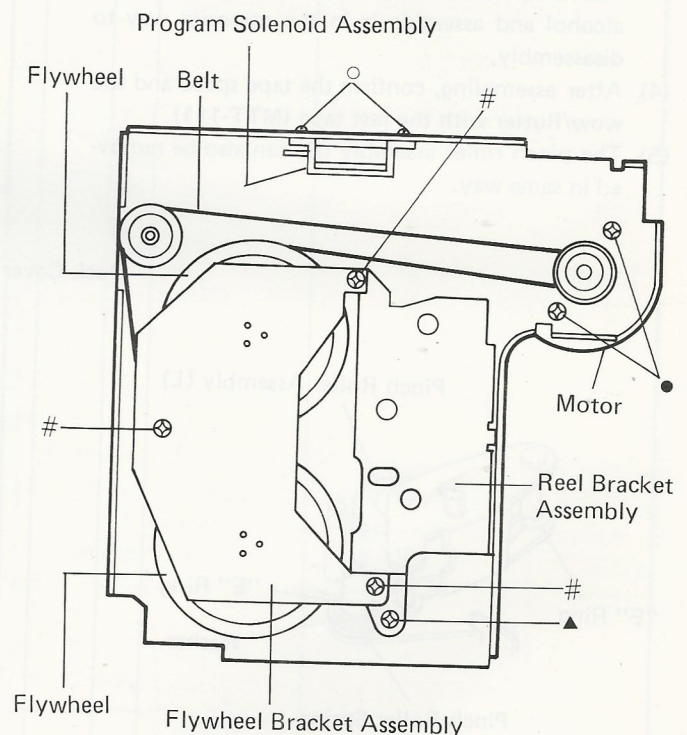

Figure 6

9. Replacement of Reed Switch and Reels

- (1) Remove two flywheels.
- (2) Remove one screw marked "▲" as shown in Figure 6.
- (3) Remove two screws marked "■" to remove the guide bracket rivet as shown in Figure 7.
- (4) Remove B.T. spring to take off the reel bracket as shown in Figure 7.
- (5) Remove two screws marked "★" and the lead wires to take off the reed switch P.C. Board as shown in Figure 8.
- (6) Remove two lock washers to take off two reels as shown in Figure 8.
- (7) When installing the reel bracket assembly after replacing the reels with new ones and the reed switch P.C. Board, pull it toward the flywheel and assemble it in the opposite way to disassembly.
- (8) After assembling, confirm the tape speed and the wow/flutter with the test tape (MTT-111).

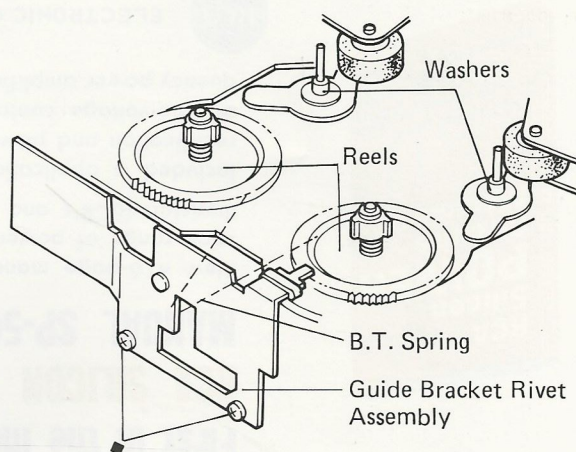

Figure 7

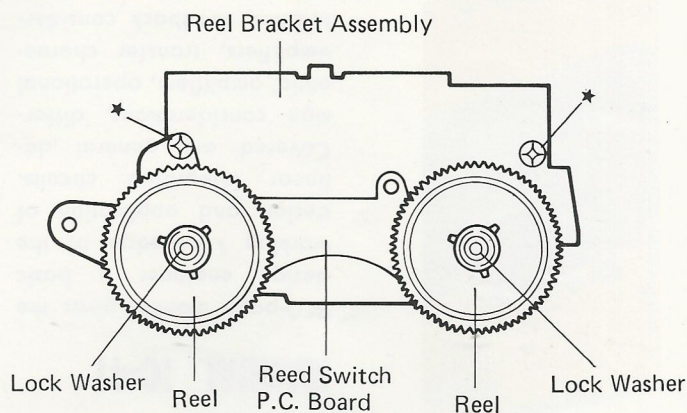

Figure 8