

# **////ALPINE<sup>®</sup> SERVICE MANUAL**

## **Cassette Deck Mechanism**

### **ADDENDUM & REVISED (VI)**

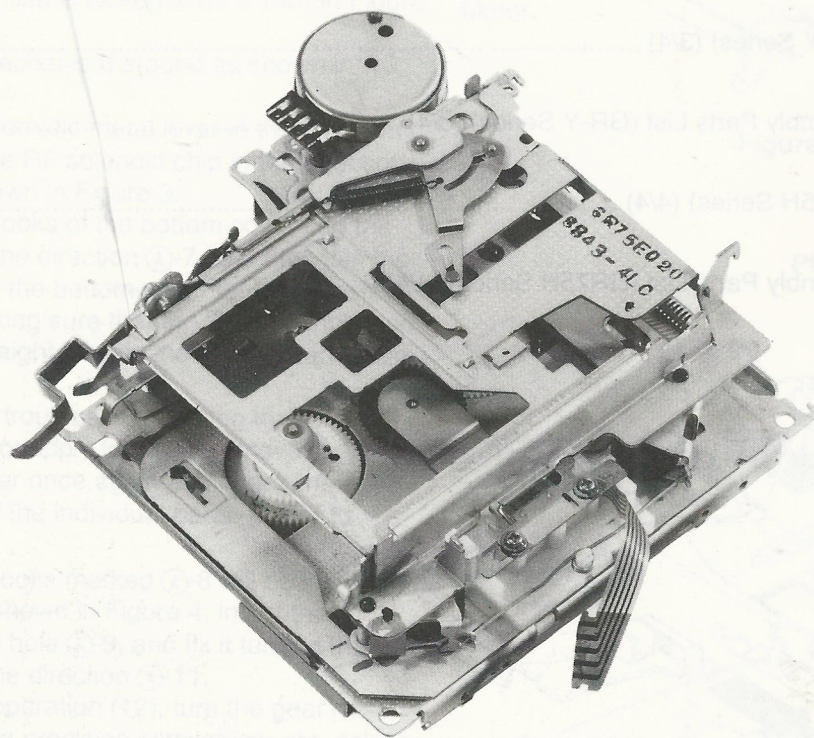

# **GR/GR-Y SERIES**



## Contents

List of Usable Lock Washers .....	3
List of Usable Oil .....	3
List of Usable Jigs .....	3
Disassembly, Assembly and Replacement of Functional Parts .....	5 to 16
Exploded View (GR75E Series) (1/4) .....	17 to 18
Cassette Deck Assembly Parts List (GR75E Series) (1/4) .....	19 to 20
Exploded View (GR75L Series) (2/4) .....	21 to 22
Cassette Deck Assembly Parts List (GR75L Series) (2/4) .....	23 to 24
Exploded View (GR-Y Series) (3/4) .....	25 to 26
Cassette Deck Assembly Parts List (GR-Y Series) (3/4) .....	27 to 28
Exploded View (GR75H Series) (4/4) .....	29 to 30
Cassette Deck Assembly Parts List (GR75H Series) (4/4) .....	31 to 33

## List of Usable Lock Washers

	SIZE	PARTS NO.	QUANTITY					
			GR75E Series	GR75L Series	GR-Y Series	GR75H 020/030/ 120/130	GR75H 12A/13A	GR75H 110
1	(M1.2 × 3.5 × 0.25)	04B41345P01	4	4	4	2	2	2
2	(M1.7 × 3.5 × 0.25)	04B41345P02	1	1	1	4	6	4
3	(M1.2 × 2.5 × 0.25)	04B41345P11	8	8	8	9	9	9
4	(M1.7 × 3.5 × 0.35)	04B41345P12	2	2	2	2	2	0
5	(M1.2 × 3.5 × 0.35)	04B41345P15	2	2	2	2	2	2
6	(M1 × 2.5 × 0.25)	04B41345P17	1	1	1	2	2	2
7	(M2.6 × 5 × 0.25)	04B41345P29	1	1	1	1	1	1
8	(M3.1 × 8 × 0.05)	04B41345P30	1	1	1	1	1	1
9	(M3.1 × 5 × 0.35)	04B41345P32	2	2	2	2	2	2
10	(M1.2 × 2.5 × 0.3)	04B41345P34	1	1	1	0	0	0
11	(M1.7 × 2.8 × 0.25)	04B41345P35	1	1	1	2	2	2
12	(M2.1 × 4 × 0.25)	04B41345P37	1	1	1	0	0	0
13	(M2.1 × 4 × 0.13)	04S40075G05	2	2	2	3	4	1
14	(M2.1 × 4 × 0.3)	04S40075G58	0	0	0	1	1	-1
15	(M2.1 × 5.5 × 0.5)	04S40075G62	0	0	0	1	1	1
16	(M2.1 × 5.5 × 0.13)	04S40075G63	0	0	0	1	1	1

## List of Usable Oil

- 1) Molykote G paste
- 2) Grease EM-30L
- 3) Grease PG-671

## List of Usable Jigs

- 1) GR bottom gear jig (Part No. 44A20788W01)
- 2) Head height adjustment gauge  
AI-500 (Part No. AI-500)



Memo



1. Assembly and Assembly of Bottom Cover

(1) The motor is mounted on the base as shown in Figure 1.

(2) Remove the gear (2) as shown in Figure 2.

(3) Remove the gear (3) as shown in Figure 3.

(4) Put the bottom cover slowly from the position shown in Figure 4 and fix it to the motor and remove the bottom cover as shown in Figure 5.

(5) Then the mechanism is shown in Figure 6.

(6) Put the gear (2) in the direction of the arrow as shown in Figure 7.

(7) Put the gear (3) in the direction of the arrow as shown in Figure 8.

(8) Put the gear (4) in the direction of the arrow as shown in Figure 9.

(9) Put the gear (5) in the direction of the arrow as shown in Figure 10.

(10) Put the gear (6) in the direction of the arrow as shown in Figure 11.

(11) Put the gear (7) in the direction of the arrow as shown in Figure 12.

(12) Put the gear (8) in the direction of the arrow as shown in Figure 13.

(13) Put the gear (9) in the direction of the arrow as shown in Figure 14.

(14) Put the gear (10) in the direction of the arrow as shown in Figure 15.

(15) Put the gear (11) in the direction of the arrow as shown in Figure 16.

(16) Put the gear (12) in the direction of the arrow as shown in Figure 17.

(17) Put the gear (13) in the direction of the arrow as shown in Figure 18.

(18) Put the gear (14) in the direction of the arrow as shown in Figure 19.

(19) Put the gear (15) in the direction of the arrow as shown in Figure 20.

(20) Put the gear (16) in the direction of the arrow as shown in Figure 21.

(21) Put the gear (17) in the direction of the arrow as shown in Figure 22.

(22) Put the gear (18) in the direction of the arrow as shown in Figure 23.

(23) Put the gear (19) in the direction of the arrow as shown in Figure 24.

(24) Put the gear (20) in the direction of the arrow as shown in Figure 25.

(25) Put the gear (21) in the direction of the arrow as shown in Figure 26.

(26) Put the gear (22) in the direction of the arrow as shown in Figure 27.

(27) Put the gear (23) in the direction of the arrow as shown in Figure 28.

(28) Put the gear (24) in the direction of the arrow as shown in Figure 29.

(29) Put the gear (25) in the direction of the arrow as shown in Figure 30.

(30) Put the gear (26) in the direction of the arrow as shown in Figure 31.

(31) Put the gear (27) in the direction of the arrow as shown in Figure 32.

(32) Put the gear (28) in the direction of the arrow as shown in Figure 33.

(33) Put the gear (29) in the direction of the arrow as shown in Figure 34.

(34) Put the gear (30) in the direction of the arrow as shown in Figure 35.

(35) Put the gear (31) in the direction of the arrow as shown in Figure 36.

(36) Put the gear (32) in the direction of the arrow as shown in Figure 37.

(37) Put the gear (33) in the direction of the arrow as shown in Figure 38.

(38) Put the gear (34) in the direction of the arrow as shown in Figure 39.

(39) Put the gear (35) in the direction of the arrow as shown in Figure 40.

(40) Put the gear (36) in the direction of the arrow as shown in Figure 41.

(41) Put the gear (37) in the direction of the arrow as shown in Figure 42.

(42) Put the gear (38) in the direction of the arrow as shown in Figure 43.

(43) Put the gear (39) in the direction of the arrow as shown in Figure 44.

(44) Put the gear (40) in the direction of the arrow as shown in Figure 45.

(45) Put the gear (41) in the direction of the arrow as shown in Figure 46.

(46) Put the gear (42) in the direction of the arrow as shown in Figure 47.

(47) Put the gear (43) in the direction of the arrow as shown in Figure 48.

(48) Put the gear (44) in the direction of the arrow as shown in Figure 49.

(49) Put the gear (45) in the direction of the arrow as shown in Figure 50.

(50) Put the gear (46) in the direction of the arrow as shown in Figure 51.

(51) Put the gear (47) in the direction of the arrow as shown in Figure 52.

(52) Put the gear (48) in the direction of the arrow as shown in Figure 53.

(53) Put the gear (49) in the direction of the arrow as shown in Figure 54.

(54) Put the gear (50) in the direction of the arrow as shown in Figure 55.

(55) Put the gear (51) in the direction of the arrow as shown in Figure 56.

(56) Put the gear (52) in the direction of the arrow as shown in Figure 57.

(57) Put the gear (53) in the direction of the arrow as shown in Figure 58.

(58) Put the gear (54) in the direction of the arrow as shown in Figure 59.

(59) Put the gear (55) in the direction of the arrow as shown in Figure 60.

(60) Put the gear (56) in the direction of the arrow as shown in Figure 61.

(61) Put the gear (57) in the direction of the arrow as shown in Figure 62.

(62) Put the gear (58) in the direction of the arrow as shown in Figure 63.

(63) Put the gear (59) in the direction of the arrow as shown in Figure 64.

(64) Put the gear (60) in the direction of the arrow as shown in Figure 65.

(65) Put the gear (61) in the direction of the arrow as shown in Figure 66.

(66) Put the gear (62) in the direction of the arrow as shown in Figure 67.

(67) Put the gear (63) in the direction of the arrow as shown in Figure 68.

(68) Put the gear (64) in the direction of the arrow as shown in Figure 69.

(69) Put the gear (65) in the direction of the arrow as shown in Figure 70.

(70) Put the gear (66) in the direction of the arrow as shown in Figure 71.

(71) Put the gear (67) in the direction of the arrow as shown in Figure 72.

(72) Put the gear (68) in the direction of the arrow as shown in Figure 73.

(73) Put the gear (69) in the direction of the arrow as shown in Figure 74.

(74) Put the gear (70) in the direction of the arrow as shown in Figure 75.

(75) Put the gear (71) in the direction of the arrow as shown in Figure 76.

(76) Put the gear (72) in the direction of the arrow as shown in Figure 77.

(77) Put the gear (73) in the direction of the arrow as shown in Figure 78.

(78) Put the gear (74) in the direction of the arrow as shown in Figure 79.

(79) Put the gear (75) in the direction of the arrow as shown in Figure 80.

(80) Put the gear (76) in the direction of the arrow as shown in Figure 81.

(81) Put the gear (77) in the direction of the arrow as shown in Figure 82.

(82) Put the gear (78) in the direction of the arrow as shown in Figure 83.

(83) Put the gear (79) in the direction of the arrow as shown in Figure 84.

(84) Put the gear (80) in the direction of the arrow as shown in Figure 85.

(85) Put the gear (81) in the direction of the arrow as shown in Figure 86.

(86) Put the gear (82) in the direction of the arrow as shown in Figure 87.

(87) Put the gear (83) in the direction of the arrow as shown in Figure 88.

(88) Put the gear (84) in the direction of the arrow as shown in Figure 89.

(89) Put the gear (85) in the direction of the arrow as shown in Figure 90.

(90) Put the gear (86) in the direction of the arrow as shown in Figure 91.

(91) Put the gear (87) in the direction of the arrow as shown in Figure 92.

(92) Put the gear (88) in the direction of the arrow as shown in Figure 93.

(93) Put the gear (89) in the direction of the arrow as shown in Figure 94.

(94) Put the gear (90) in the direction of the arrow as shown in Figure 95.

(95) Put the gear (91) in the direction of the arrow as shown in Figure 96.

(96) Put the gear (92) in the direction of the arrow as shown in Figure 97.

(97) Put the gear (93) in the direction of the arrow as shown in Figure 98.

(98) Put the gear (94) in the direction of the arrow as shown in Figure 99.

(99) Put the gear (95) in the direction of the arrow as shown in Figure 100.



# Disassembly, Assembly and Replacement of Functional Parts

## 1. Disassembly and Assembly of Bottom Cover

- (1) Turn the mechanism around as shown in Figure 1.
- (2) Remove M1 lock washer ① as shown in Figure 1.
- (3) Remove three screws ② as shown in Figure 1.
- (4) Lift the bottom cover slowly from the position ①-A-1, pull the hooks out of the holes in the chassis, and remove the bottom cover as shown in Figure 1.
- (5) When remounting the bottom cover, first turn the front of the mechanism up as shown in Figure 2.
- (6) Slide the slider in the direction ①-A-2 as shown in Figure 2.
- (7) Push down the cassette holder in the direction ①-A-3 as shown in Figure 2.
- (8) Pull the door pin in the direction ①-A-4 so that the mechanism is locked in as shown in Figure 2.
- (9) Turn the mechanism around as shown in Figure 3.
- (10) Pull the automatic metal lever in the direction ①-A-5 and the RF solenoid chip in the direction ①-A-6 as shown in Figure 3.
- (11) Insert the hooks of the bottom cover into the chassis in the direction ①-A-7, and then join the part ①-A-8 of the bottom cover to the chassis slowly, making sure that the 3 points indicated with the straight lines in the Figure 3 are fitted properly.  
If there are troubles in mounting the bottom cover, do not apply force but remove the bottom cover once again and check the positions of the individual parts. (Refer to Figure 3.)
- (12) Since the hooks marked ①-A-8 will be lifted slightly as shown in Figure 4, insert the jig through the hole ①-A-9, and fix it turning the jig slightly in the direction ①-A-11.  
Instead of operation (12), turn the gear nose slowly with a precision screwdriver etc., taking care not to damage it.  
After 2 to 3 turns, it will click into place.  
(Refer to Figures 4 and 5.)
- (13) Fix the screws and the lock washer that have been removed.

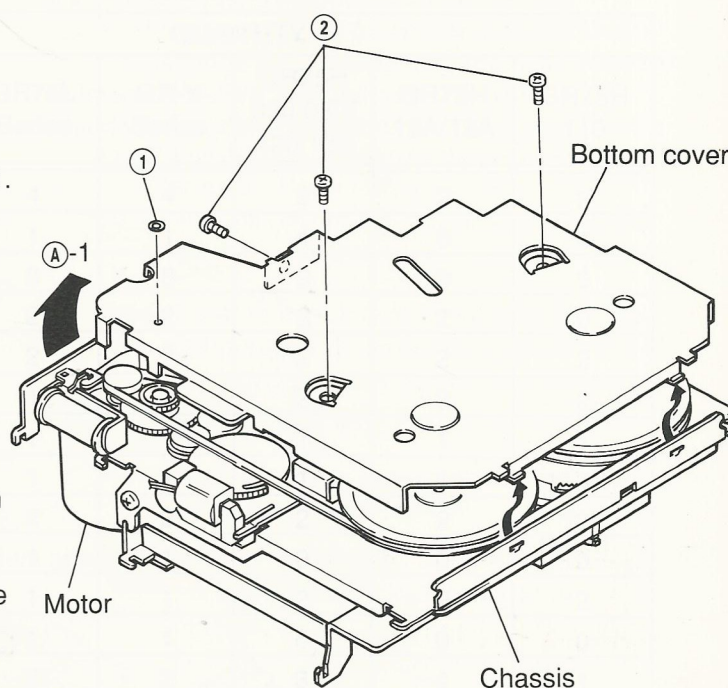

Figure 1

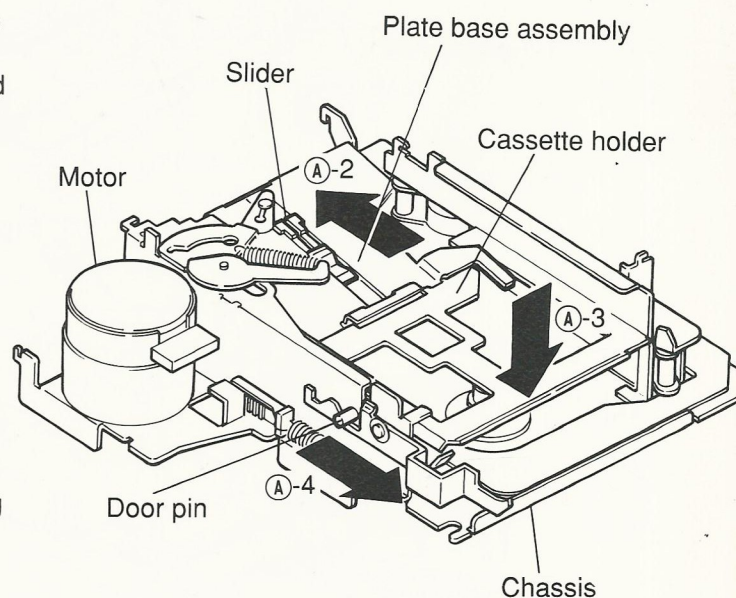

Figure 2

(14) Insert the jig into the hole (A-9) as shown in Figure and rotate the eject solenoid counterclockwise about 20 times, pulling it in the direction (A-10) with the finger. Then the eject operation is completed. Instead of operation (14), the eject operation can be performed by mounting the mechanism to the product. (Refer to Figures 4 and 5.)

**Note:** Do not reuse the used lock washers for mounting.  
When turning the mechanism, be careful not to drop the gear and the flywheel.  
Fasten the three screws with a fastening torque of 6 kg.cm.

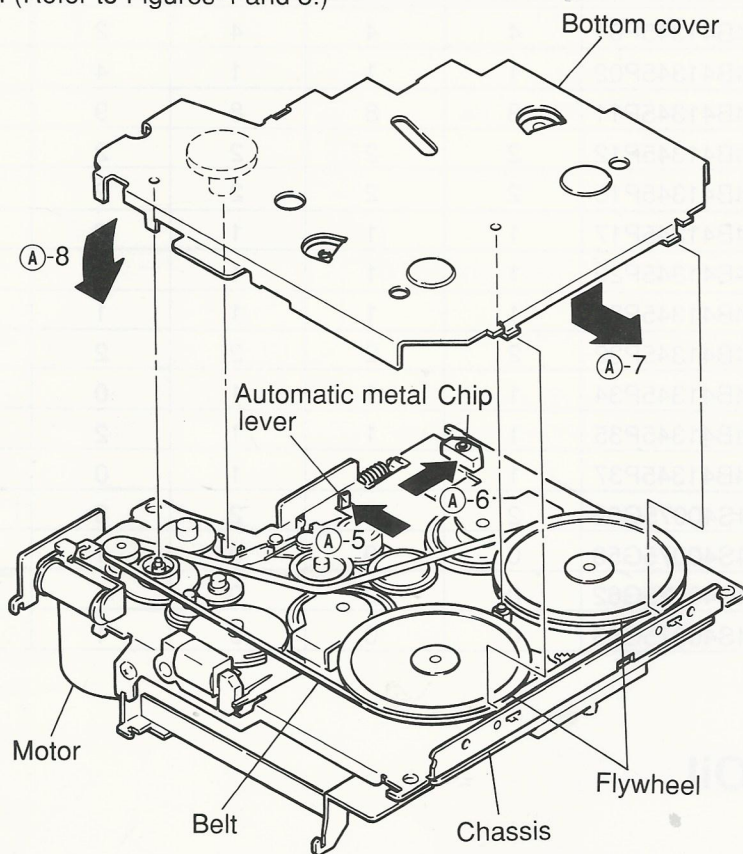

Figure 3

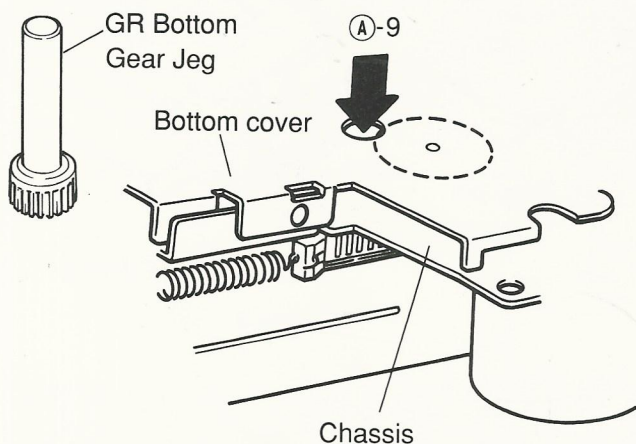

Figure 4

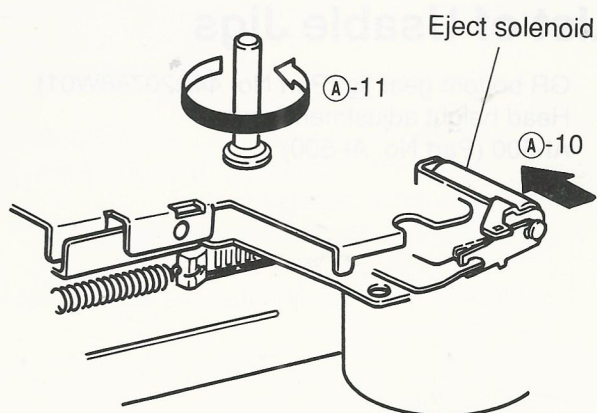

Figure 5



## 2. Replacement of the bottom cover mounting parts

### a. Replacement of the eject gear

- (1) Remove M1.2 lock washer ③ as shown in Figure 6.
- (2) Pull the eject pinion out of the eject gear and remove the eject gear as shown in Figure 6.
- (3) Apply the molykote E paste to the section B-1, and mount the eject gear following the removal steps in the reverse order. After replacement is finished, make sure that the gear rotates smoothly. (Refer to Figure 6.)

**Note:** Do not reuse the used lock washers for remounting.  
Take care to avoid damage by piercing and tearing.

### b. Replacement of the RF solenoid

- (1) Remove two solders ④ and remove the RF solenoid from the bottom cover by pulling it up as shown in Figure 6.
- (2) Replace the solenoid with a new one, and remount it following the removal steps in the reverse order as shown in Figure 6.

**Note:** When removing solder ④, set the temperature of the soldering iron to  $350^{\circ} \pm 10^{\circ}$  and the soldering time to 1 – 3 seconds. Take care that the solder is not loose, that there is no shortcircuit and that the coating is not damaged.

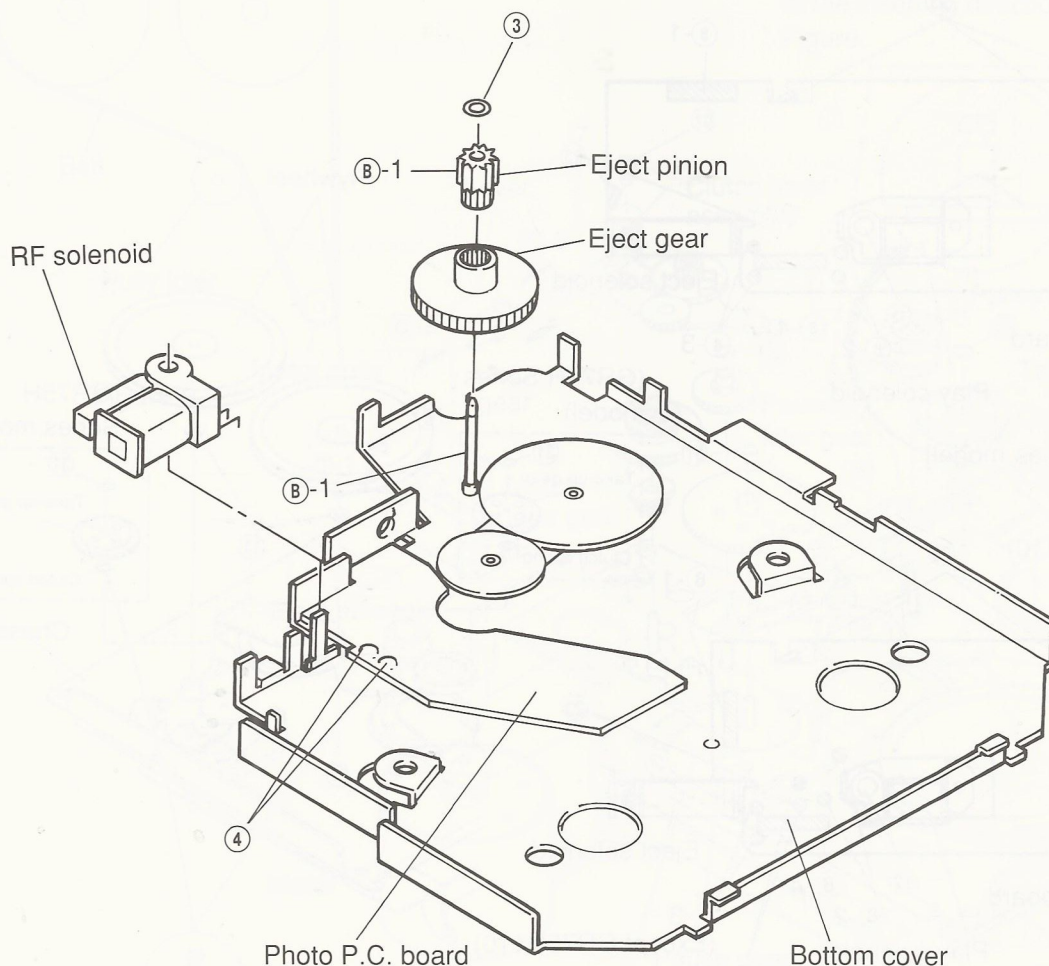

Figure 6

c. Replacement of the photo sensor

- (1) Remove four solders ⑤ as shown in Figure 7.
- (2) Remove the photo guide together with the photo sensor from the photo P.C. board as shown in Figure 7.
- (3) Insert the new photo sensor into the photo guide, and bend the legs of the photo sensor in the direction marked ⑧-2 as shown in Figure 7.
- (4) Insert the photo guide into the P.C. board and solder the legs so that the photo sensor is set as indicated by [ ] in Figure 7.

**Note:** When using the soldering iron, set the temperature of the soldering iron to  $350^{\circ} \pm 10^{\circ}$  and the soldering time to 1 – 3 seconds. Take care that the solder is not loose, that there is no shortcircuit and that the coating is not damaged. Also take care that the photo guide is properly fixed and straight.

d. Replacement of the detector switch  
(Automatic metal pack-in)

- (1) Remove 4 solders ⑥ with which the switch is fixed as shown in Figure 7.
- (2) Prepare the terminals of the switch of the new solder as shown in Figure 8.
- (3) After that, insert the switch into the photo P.C. board, and solder the terminals.

**Note:** When using the soldering iron, refer to Item 2-C to make sure that the temperature of the soldering iron and the soldering time are proper. Also take care that the switch guide is properly fixed and straight.

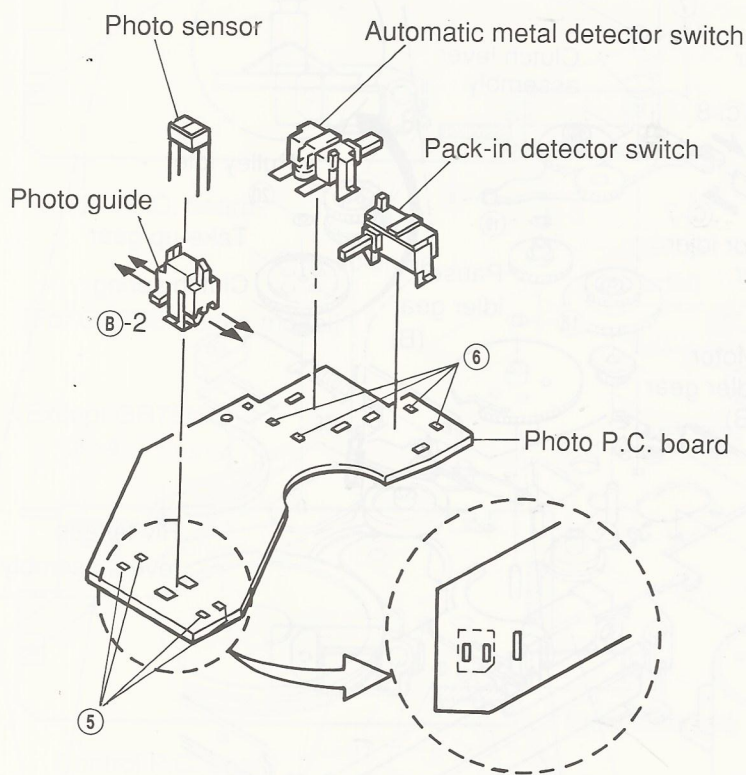

Figure 7

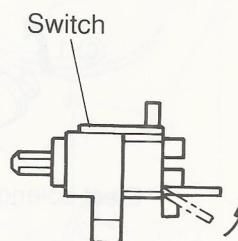

Figure 8



### 3. Replacement of the mounting parts on the rear of the main chassis

#### a. Replacement of the belt

- (1) After removing the bottom cover, remove the belt.
- (2) Clean the new belt with absolute alcohol, and fix it as shown in Figure 9.

**Note:** When fixing the belt, make sure that it is not twisted or dirty. When removing the belt, do not turn up the front of the chassis.

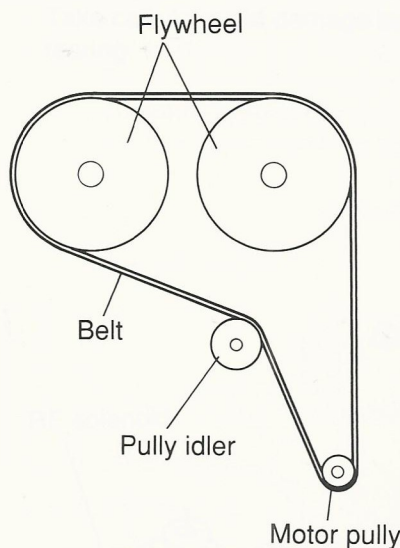

Figure 9

#### b. Replacement of the motor

- (1) After removing the belt, remove spring ⑦ as shown in Figure 10.
- (2) Remove solder ⑧-1, and remove the parallel wire (5P) from the control P.C. board as shown in Figure 11.
- (3) Remove two screws ⑨ and ⑩, and remove the motor, taking care not to damage the motor idler gear. (Refer to Figure 10.)
- (4) Mount the new motor following the removal steps in the reverse order.

**Note:** Refer to Item 2-C to make sure that the temperature of the soldering iron and the soldering time are proper. Since the parallel wire is very easily damaged, handle it with care.

Fasten the two screws with a fastening torque of 3 kg.cm.

\*When inserting the clutch spring, be careful of the inserting direction as shown in the Figure.

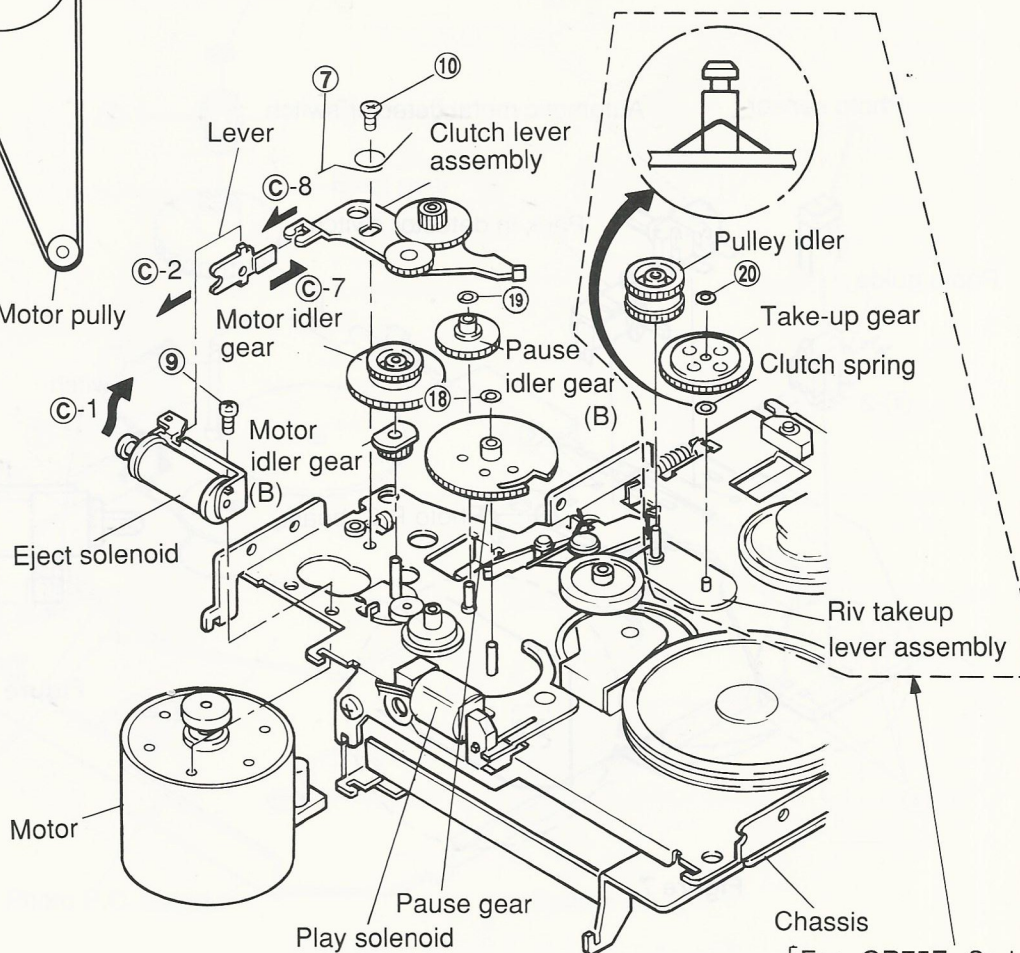

Figure 10

For GR75E Series  
GR75L Series  
GR-Y Series  
models

c. Replacement of the flywheels

- (1) After removing the belt, pull out the two flywheels. Take care not to loose the polyslider washer (11) located between the flywheel and the chassis. (Refer to Figure 12.)
- (2) Fix the polyslider washer to the new flywheel and mount the flywheel to the chassis.

d. Replacement of the play solenoid

- (1) Remove the two solders (8-2) as shown in Figure 11.
- (2) Remove one screw (12) and remove the solenoid as shown in Figure 11.
- (3) Mount the new solenoid following the removal steps in the reverse order.

**Note:** Refer to Item 2-C to make sure that the temperature of the soldering iron and the soldering time are proper. Fasten the screws with a fastening torque of 2.3 kg.cm.

e. Replacement of the eject solenoid

- (1) Remove two solders (8-3). Take care not to loose the tube that protects the wire. (Refer to Figure 11.)
- (2) Remove screw (9) and remove the solenoid as shown in Figure 10.
- (3) Align position (C)-1 of the new solenoid with position (C)-2 of the lever and fasten the screw as shown in Figure 10.
- (4) Lead the wire through the tube and solder it.

**Note:** Refer to Item 2-C to make sure that the temperature of the soldering iron and the soldering time are proper. Fasten the screws with a fastening torque of 3 kg.cm. As the solenoid wires are not insulated, do not let them cross each other.

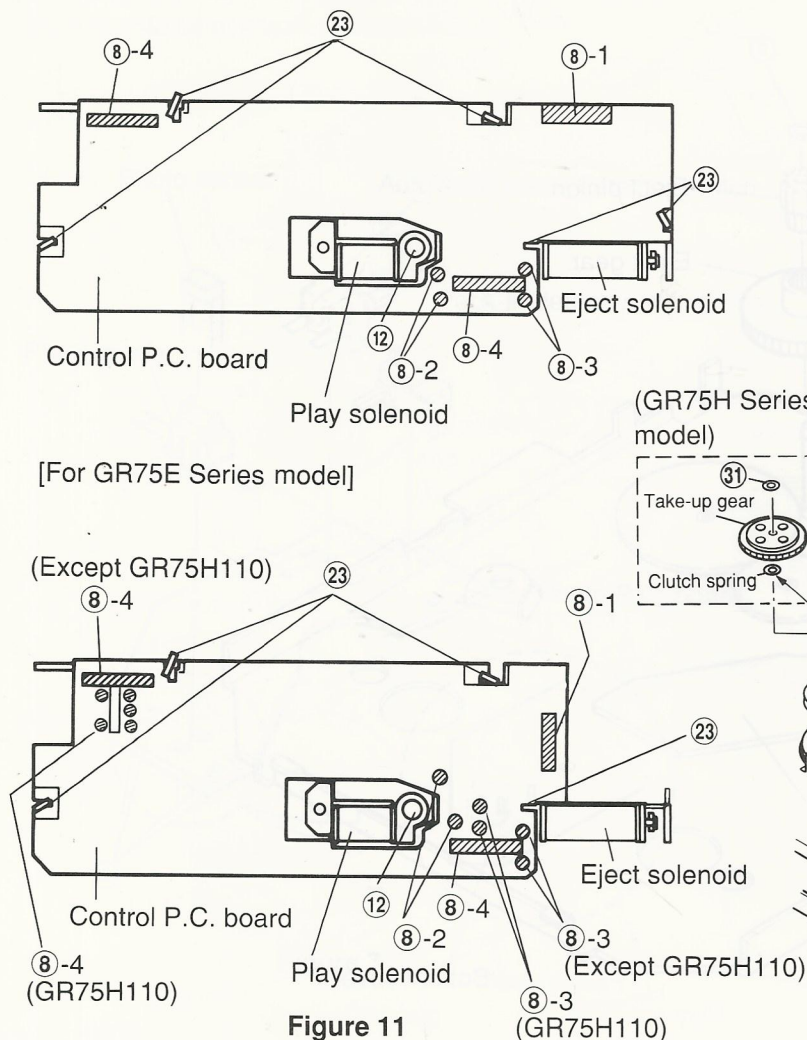

Figure 11

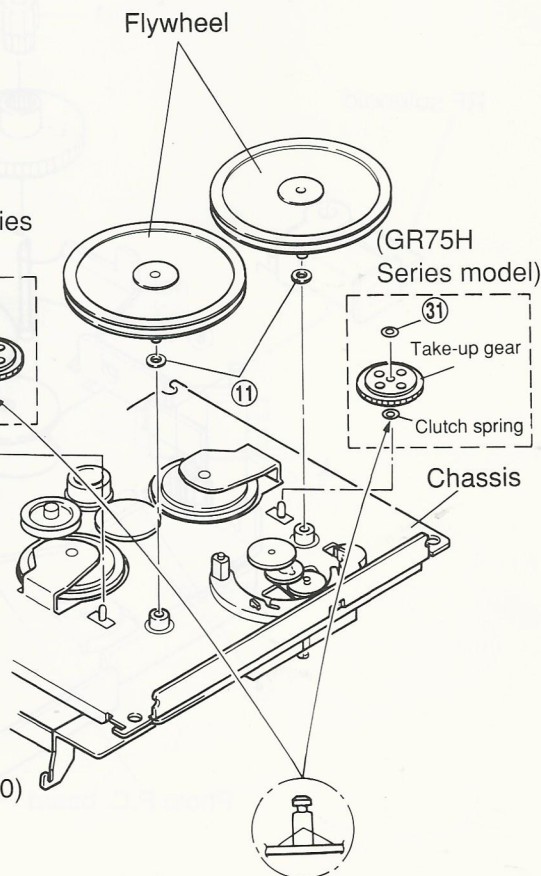

Figure 12

[For GR75L Series  
GR-Y Series  
GR75H Series models]



## f. Replacement of gears

## (f-1) Replacement of the reverse idler gear

- (1) Remove M1.2 lock washer (13), pull it up from the stud of the chassis and remove the gear as shown in Figure 13.
- (2) Remount following the removal steps in the reverse order.

## (f-2) Replacement of the sun gear

- (1) Remove M1.2 lock washer (14), pull it up from the stud of the chassis and remove the gear as shown in Figure 13.
- (2) Mount it, following the removal steps in the reverse order.

## (f-3) Replacement of the fixing gear

- (1) Adjust the two mounting claws for the fix gear on the chassis (15) and remove the section C-3 of the gear by pulling it up in the direction of the arrow shown in Figure 13.
- (2) Insert the section C-4 of the new gear into the chassis, and mount it following the removal steps in the reverse order as shown in Figure 13.

## (f-4) Replacement of the reverse lever assembly and planet gear

- (1) Remove both the fixing gear and the sun gear and remove the reverse lever assembly as shown in Figure 13.
- (2) Remove M1.7 lock washer (16) and remove the planet gear as shown in Figure 14.
- (3) Mount the new planet gear and reverse lever following the removal steps in the reverse order.

**Notes on f-1 through f-4:**

After mounting all parts, check if the reverse lever moves in the directions marked C-5 when the reverse gear is turned clockwise and counterclockwise.

\* After mounting the fixing gear, bend the claws (15) into the form of as shown in the Figure.

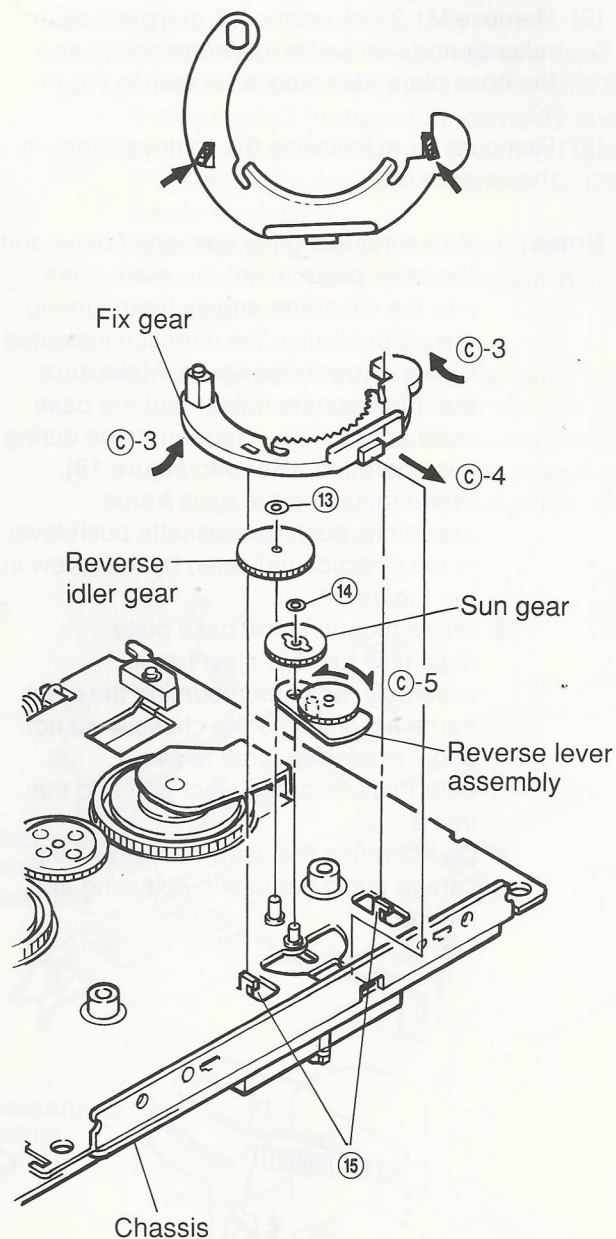

Figure 13

- (f-5) Replacement of the clutch lever assembly and eject idler gear
- (1) After removing the motor, remove the motor idler gear and the motor idler gear (B) and remove the clutch lever assembly as shown in Figure 10.
  - (2) Remove M1.2 lock washer ⑰ and remove the eject idler gear as shown in Figure 15.
  - (3) Mount the new gears and clutch lever following the removal steps in the reverse order.

**Note:** When mounting the gears to the lever, apply grease (PG-671) to the position ㉔-6 as shown in Figure 15. Align the position ㉔-7 with the position ㉔-8 and mount the clutch lever as shown in Figures 10 and 15.

- (f-6) Replacement of the pause gear
- (1) Remove M1.2 lock washer ⑱ and remove the pause gear pulling it up from the stud of the chassis as shown in Figure 10.
  - (2) Mount the new gear following the removal steps in the reverse order.

- (f-7) Replacement of the pause idler gear (B)
- (1) After removing the motor and the motor idler gear, remove M1.2 lock washer ⑲ and remove the gear by pulling it up from the stud of the chassis as shown in Figure 10.
  - (2) Mount the new gear by following the removal steps in the reverse order.

- (f-8) Replacement of the take-up gear
- (1) After removing the belt and the pulley idler gear, remove M1.2 lock washer ⑳ by pulling it up from the stud of the riv take-up lever assembly as shown in Figure 10. [For GR75E Series, GR75L Series, GR-Y Series models] After removing the Flywheel, remove M1.2 lock washer ㉑ and remove the gear by pulling it up from the stud of the chassis as shown in figure 12. [For GR75H Series model]
  - (2) Remount the take-up gear following the removal steps in the reverse order.

**Notes on f:**

Do not reuse the used washers. Take care to avoid damage by piercing and tearing.

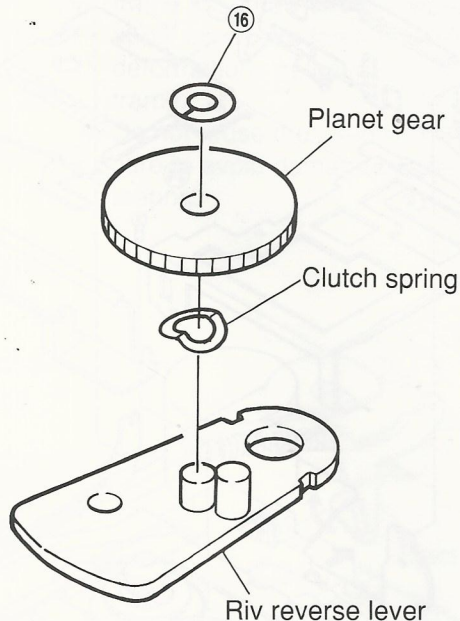

[Disassembly Reverse Lever Assembly]

**Figure 14**

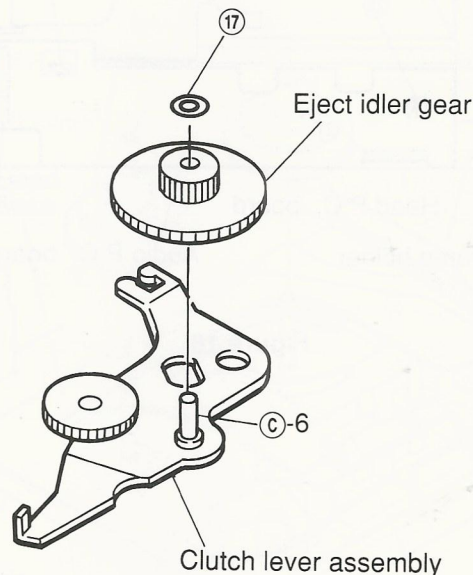

**Figure 15**



#### 4. Replacement of the parts mounted on the front of the main chassis

##### a. Replacement of the audio P.C. board (Except GR75H110)

- (1) Remove two solders (21) and remove the parallel wire (7P) and the head P.C. board as shown in Figure 16.
- (2) Adjust the two claws (22) to the rectangular holes on the P.C. board and remove the P.C. board as shown in Figure 16.
- (3) After replacement, mount the new P.C. board following the removal steps in the reverse order.

**Note:** The head P.C. board and the parallel wire are easily damaged. Handle them with care. Refer to Item 2-C to make sure that the temperature of the soldering iron and the soldering time are proper. Do not bring the soldering iron near the head P.C. board.

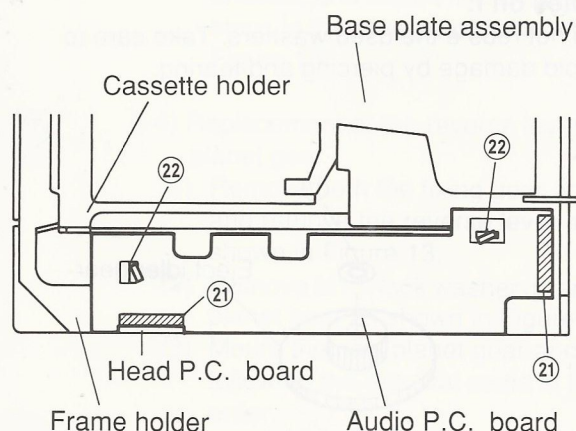

Figure 16

##### b. Replacement of the control P.C. board

- (1) Remove seven solders (8) and remove the three parallel wires and the wires of the eject solenoid and of the play solenoid as shown in Figure 11.
- (2) Remove five claws (23) and remove the P.C. board as shown in Figure 11. [For GR75E Series model] Remove four claws (23) and remove the P.C. board as shown in Figure 11. [For GR75L Series, GR-Y Series, GR75H Series models]
- (3) After replacing the old P.C. board with a new one, mount it following the removal steps in the reverse order.

**Note:** As mentioned in Item 4-a, handle the parallel wires carefully, and be sure that the temperature of the soldering iron and the soldering time are proper. As the wires of the eject solenoid are not insulated, do not let them cross each other.

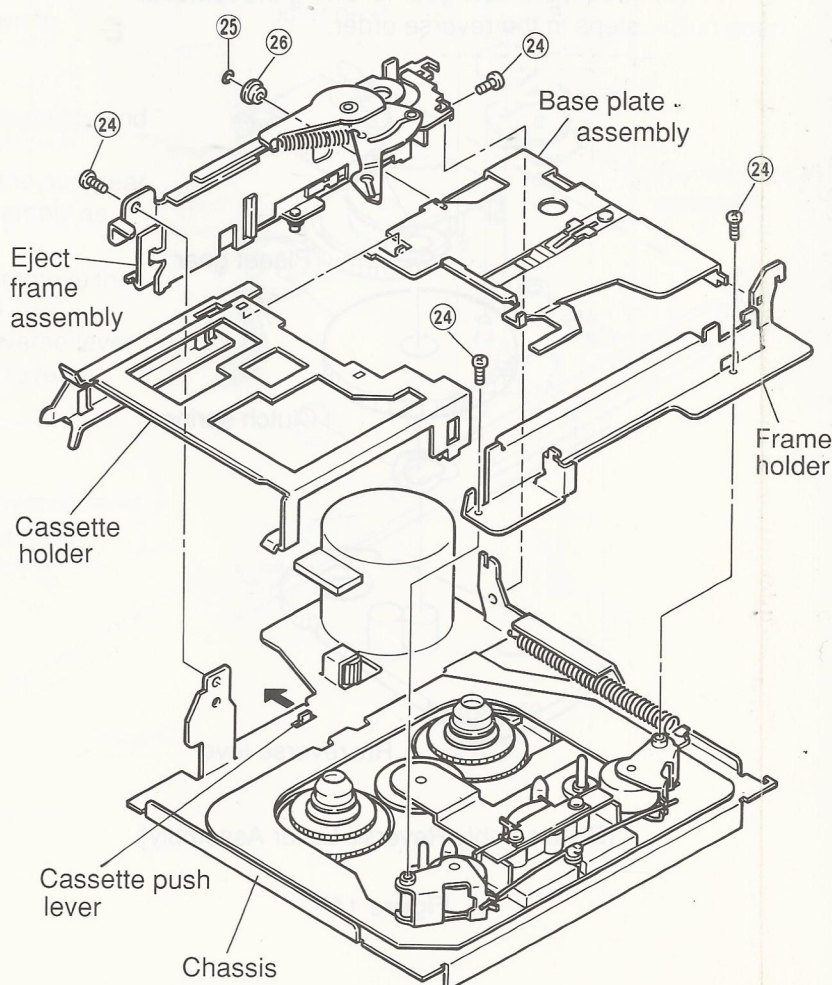

Figure 17



c. Disassembly and assembly of the cassette holder

- (1) Remove four screws (24) and remove the eject frame assembly and the frame holder as shown in Figure 17.
- (2) Remove M1.2 lock washer (25) and plate base roller (26) and remove the cassette holder and the base plate assembly as shown in Figure 17.
- (3) Remount them following the removal steps in the reverse order.

- Notes:**
1. When mounting the cassette holder and the base plate, insert the slider shaft into the eject arm and fix them turning the slider shaft in the direction indicated by the arrow in the figure. Make sure that the cassette holder and the base plate are in the cassette-in mode during this operation. (Refer to Figure 18).
  2. When mounting the eject frame assembly, push the cassette push lever in the direction indicated by the arrow in the Figure 17.
  3. When mounting the base plate assembly and the eject frame assembly, or when mounting the eject frame assembly to the chassis, do not apply excessive force to avoid deformations of the eject arm and the frame.
  4. Do not reuse the used washers. Take care to avoid damage by piercing and tearing.

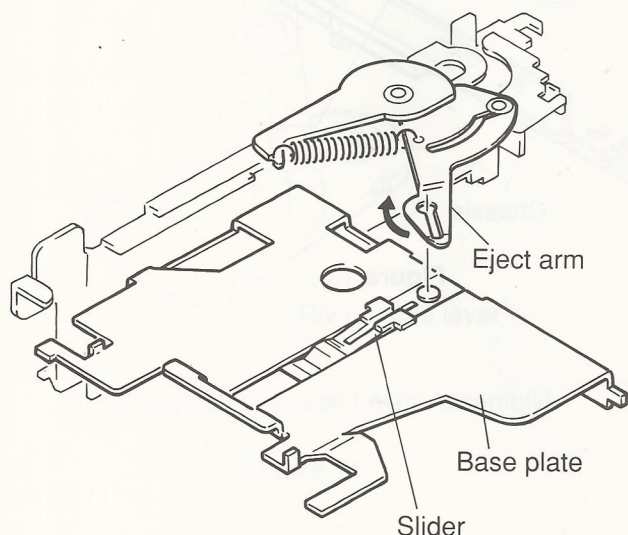

Figure 18

d. Replacement of the reels

- (1) Remove M1.7 two lock washers (26) (Refer to figure 19).
- (2) Move the select lever in the direction marked D-1 in the Figure and remove the reel by gripping the reel gear as shown in Figure 19.
- (3) After replacement, mount the new reels following the removal steps in the reverse order.
- (4) After mounting, check the tape speed and the wow and flutter with test tape MTT-111.

**Note:** Since the reel is easily loosened if the cap is gripped, always handle it gripping the gear. Do not reuse the used washers. Take care to avoid damage by piercing and tearing.

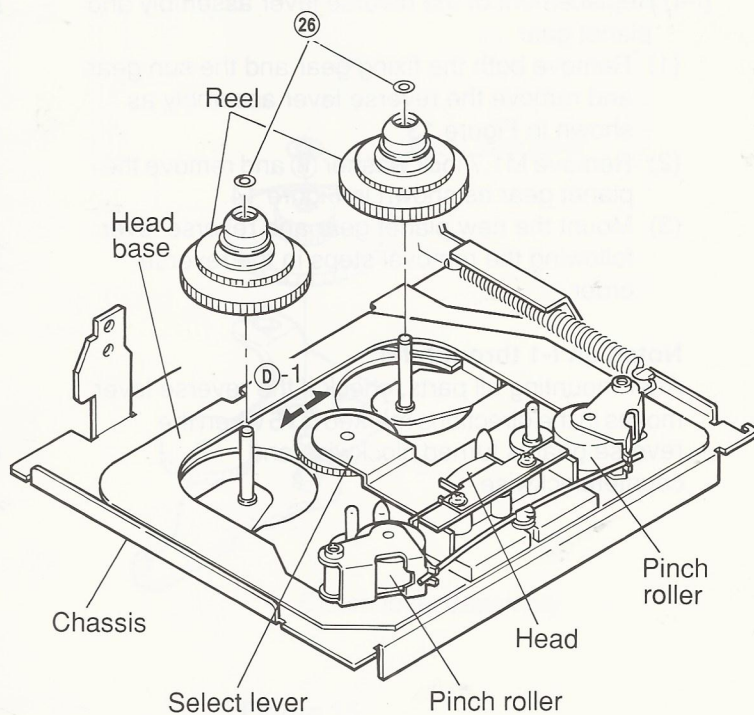

Figure 19



## e. Replacement of the pinch rollers

- (1) Remove pinch roller spring ②⑦ as shown in Figure 20.
- (2) Remove M3.1 two lock washers ②⑧ and remove the pinch roller as shown in Figure 20.
- (3) Mount the pinch rollers following the removal steps in the reverse order.  
Apply insulation coating to the position ①-2 of the pinch roller as shown in Figure 20.

**Note:** Make sure that the pinch rollers are thoroughly fixed and that they are not deformed. Do not reuse used lock washers. Take care to avoid damage by piercing and tearing.

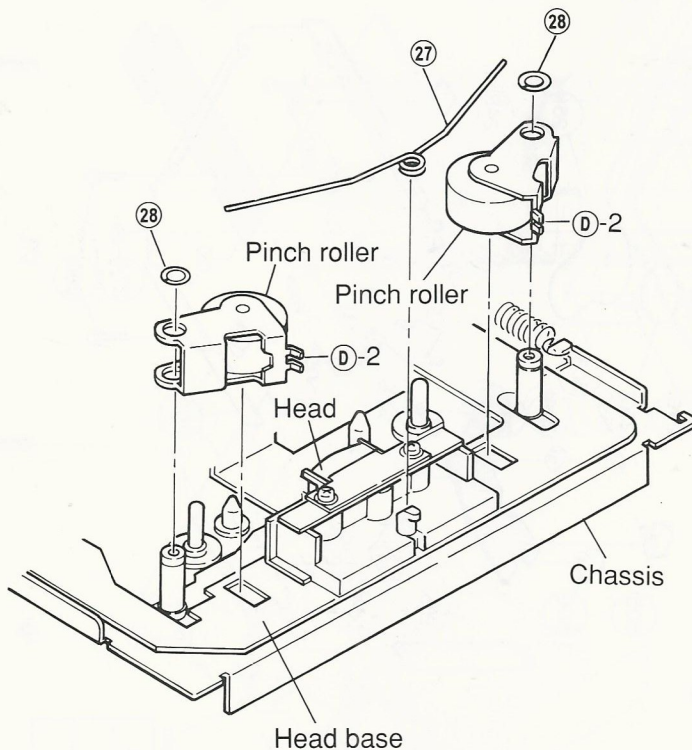

Figure 20

## f. Replacement of the head

- (1) After removing the pinch roller spring, remove two screws ②⑨ as shown in Figure 21.
- (2) Remove solder ③⑩ and remove the head from the head P.C. board as shown in Figure 22.
- (3) After replacement, mount the new head following the removal steps in the reverse order.

**Notes:** 1. Refer to Item 2-C to make sure that the temperature of the soldering iron and the soldering time are proper. Do not bring the soldering iron near the head P.C. board. Make sure that the head P.C. board is not lifted.  
2. Fasten the two screws with a fastening torque of 2.3 kg.cm. Note that the tension of the head spring can be decreased if the screws are fastened too strongly.

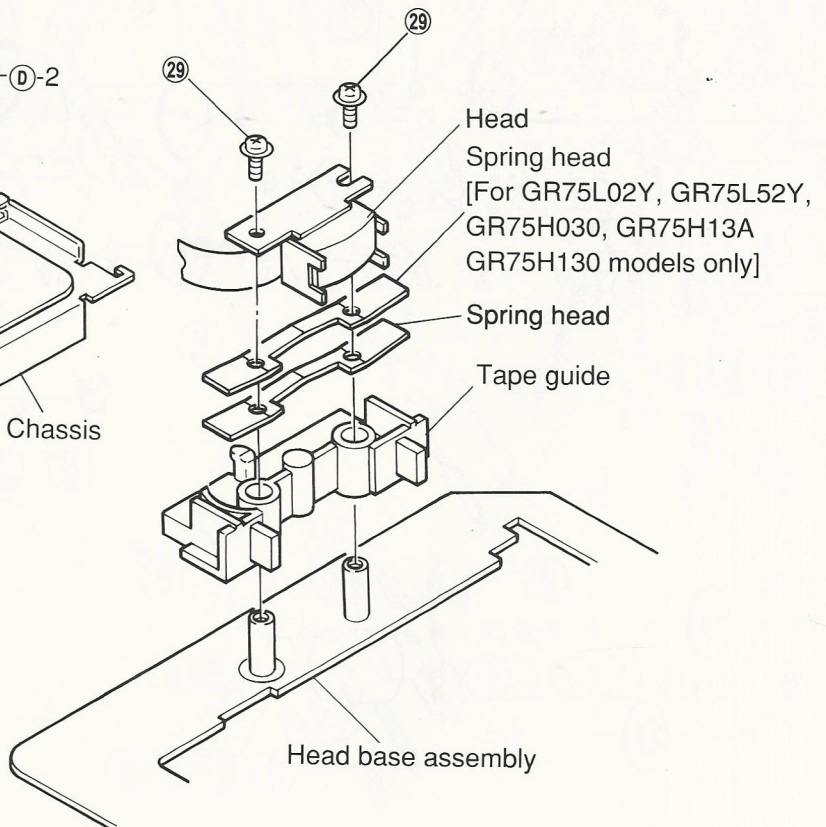

Figure 21

- (4) Adjust the height of the head as shown in Figures 23, 24 and 25.
- ① Place the height adjustment gauge (AI-500) on the head base, and adjust the height so that the check bar fits in the tape head guide smoothly.
  - ② When the check bar touches the top (or bottom) of the tape guide, insert a spacer (t 0.1 mm or polislider washer t 0.13 mm). If necessary, remove the spacer.

**Note:** If you do not have a height gauge like described in (4)-①, run the tape at normal speed and adjust the height of the head and the tape head guide so that the tape does not curl.

- (5) After having assembled the complete mechanism, adjust the angle of the head with test tape MTT-113C. (Refer to chapter "Adjustment of the head angle".) After the adjustment, apply the screw lock and fix the screws.

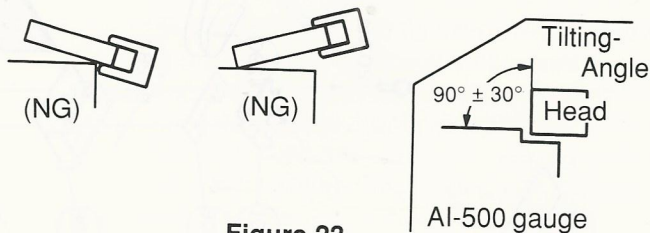

Figure 23

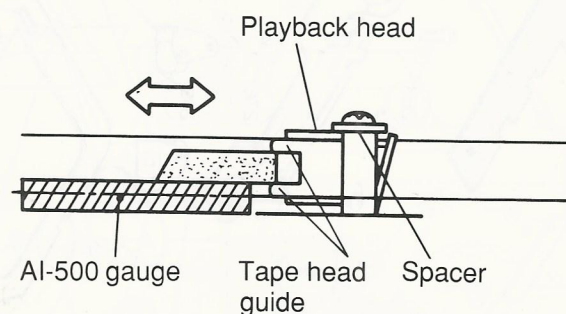

Figure 24

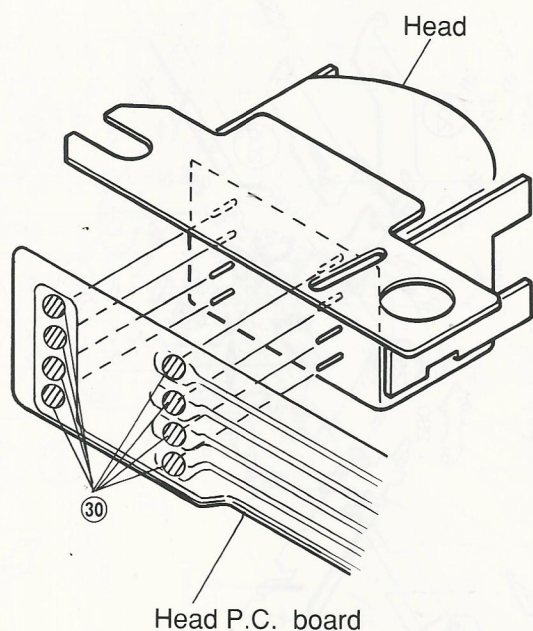

Figure 22

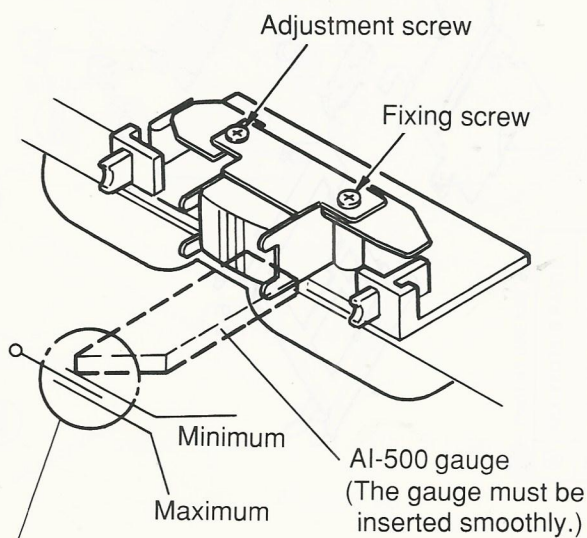
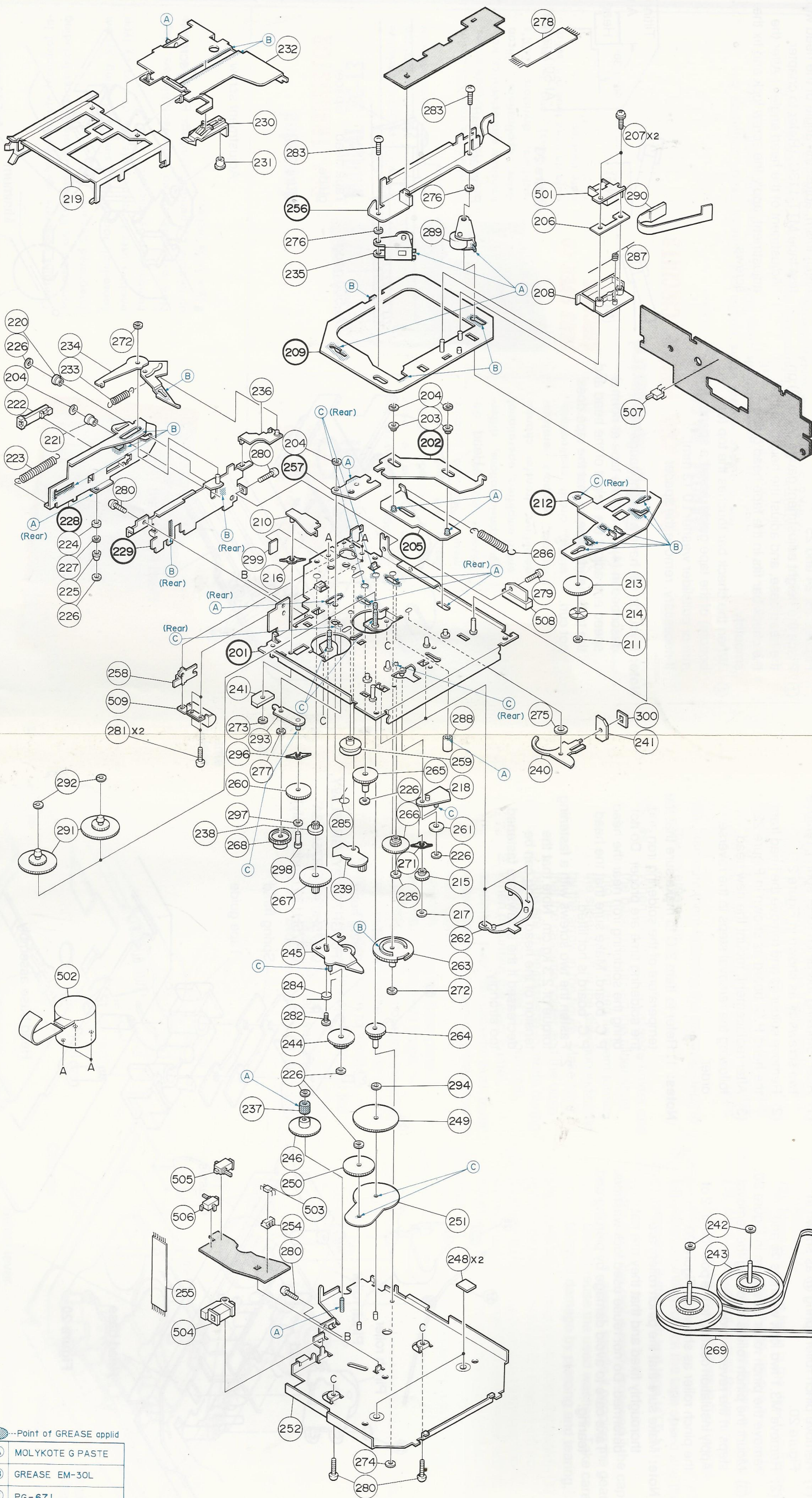

Figure 25



# Exploded View (GR75E Series) (1/4)

● For GR75E010/01A/020 Models



●	Point of GREASE applid
(A)	MOLYKOTE G PASTE
(B)	GREASE EM-30L
(C)	PG-67I

GR/GR-Y Series GR/GR-Y Series



## Cassette Deck Assembly Parts List (GR75E Series) (1/4)

Note: The parts without parts list are not supplied.

Symbol No.	IN-dex	Part No.	Description
203	3-C	43A11072W01	Roller, Sub Head
204		04B41345P01	Washer, Lock(M1.2)
206	2-B	41A31756W01	Spring, Head
207	2-B	03S40019G03	Screw, F-Locks(M2x4)
208	2-B	43B12545W01	Tape, Guide
210	4-C	01A10206W01	Assy., Riv Lever R/F Sol
211	2-D	04B41345P29	Washer, Lock(M2.6)
213	2-D	44A10295W01	Gear, Sensor
214	2-D	14A10681W01	Reflector
215	3-E	44A30480W01	Gear, Planet
216	3-E	41A10097W02	Spring, Clutch
217	3-E	04B41345P35	Washer, Lock(M1.7)
218	3-E	01A30824W01	Assy., Riv Lever Reverse
219	4-B	07B40283W01	Holder, Cassette
219	4-B	07B40283W01	Holder, Cassette
219	4-B	07B10074W01	Holder, Cassette
220	5-B	43A12583W01	Roller, Eject
221	5-C	43A63281F01	Roller, Plate Base
222	5-C	44A82206F01	Rack
223	5-C	41B10386W03	Spring, GR(Rack)
224	4-C	43A10121W01	Roller, Eject A
225	4-D	43A10360W01	Roller, Eject B
226		04B41345P11	Washer, Lock(M1.2)
227	4-D	43A12377W01	Roller, Eject C
230	4-A	45B10376W01	Slider
231	4-B	47A63278F01	Shaft, Slider
232	4-A	01A10212W01	Assy., Riv Plate Base
233	4-C	41B10386W01	Spring, Eject Arm
234	4-B	01A10148W01	Assy., Riv Eject Arm A
235	3-B	01B30863W02	Assy., Pinch Roller
236	4-C	45A10087W01	Lever Pack In SW
237	4-F	44A12975W01	Pinion, Eject
238	4-E	44A13617W01	Gear, Motor Idler(B)
239	3-E	01A10201W02	Assy., Riv Lever Pause
240	2-D	45A40725W01	Lever, Play Sol
241		76T10374W01	Chip
242	1-G	04S40075G05	Washer Polyslider(M2.1)
243	1-G	01A10368W01	Assy., Flywheel
244	3-F	44A10141W01	Gear, Eject Idler
245	3-E	01A10205W02	Assy., Riv Lever Clutch A

Symbol No.	IN-dex	Part No.	Description
246	3-F	44A10145W01	Gear, Eject
248	3-G	43A41656W01	Spacer, UHMW
249	3-F	44A11063W01	Gear, Bottom A
250	3-F	44A11064W01	Gear, Bottom B
251	3-G	34A11122W02	Washer, GR
252	3-H	01A10210W02	Assy., Riv. Cover Bottom
254	3-G	15B11065W01	Guide, Photo
255	4-G	30T15126W01	Wire, PC Sensor(7P)
258	4-D	45A10101W01	Lever, Eject Sol
259	3-D	49A10131W01	Pulley, Idler
260	4-E	44A10133W01	Gear, Take Up
261	3-E	44A10134W01	Gear, Sun
262	3-E	44B10135W01	Gear, Fix
263	3-E	44B30484W01	Gear, Pause
264	3-F	44A10137W01	Gear, Pause Idler A
265	3-D	44A10379W01	Gear, Pause Idler B
266	3-E	44A10138W01	Gear, Reverse Idler
267	3-E	44A10139W01	Gear, Motor Idler
268	4-E	44A11062W01	Gear, Reel Idler
269	1-G	42A10380W01	Belt, GR
271	3-E	41A30475W01	Spring, Clutch
272		04B41345P15	Washer, Lock(M1.2)
273	4-D	04B41345P02	Washer, Lock(M1.7)
274	3-H	04B41345P17	Washer, Lock(M1)
275	2-D	04B41345P30	Washer, Lock(M3.1)
276		04B41345P32	Washer, Lock(M3.1)
277	4-E	04B41345P37	Washer, Lock(M2.1)
278	2-A	30T15126W02	Wire, PC Joint 7P
279	2-D	03S44205G78	Screw, Pan(M2x6)
280		03S44205G30	Screw, Pan(M2.6x4)
281	4-D	03S72235F53	Screw, Pan(M2x3.3)
282	3-F	03A12132W02	Screw, Eject Clutch(M2x2.3)
283		03S43997P64	Screw, Pan(M1.7x3)
284	3-F	41A10384W01	Spring, Eject Clutch
285	3-E	41A10385W01	Spring, Cas Push
286	2-C	41B10386W02	Spring, Sub Head
287	2-B	41A10387W01	Spring, Pinch Roller
288	3-D	43A12719W01	Roller, Pause
289	3-B	01B30863W01	Assy., Pinch Roller
290	2-B	84T25151W01	Head P.C. Board

Symbol No.	IN-dex	Part No.	Description
291	4-E	01T35403W01	Assy., Reel
292	4-E	04B41345P12	Washer, Lock(M1.7)
293	4-D	01A30161W01	Assy., Riv Lever Take Up
294	3-F	04B41345P34	Washer Lock(M1.2)
296	4-D	41A40910W01	Spring, Clutch
297	4-E	43A41543W01	Washer, Som(M1.2)
298	3-E	47A41458W01	Pin, Take Up
299	4-C	43A40388W01	Spacer, Polyslider
300	2-D	43A41744W01	Lock, Solenoid
Miscellaneous			
501	2-B	88T15971W01	Head
501	2-B	88T10373W01	Head
501	2-B	88T10373W01	Head
502	4-E	01V11500W64	Assy., Motor(Main. 13.2V-80mA)
503	3-G	51T15144W01	Sensor, Photo
504	4-G	01T10371W01	R/F Sol. Assy.
505	4-F	40T15382W01	SW., Detector(Pack Down)
506	4-G	40T15382W01	SW., Detector(Metal)
507	2-C	40T15222W01	SW., Detector (Pack In)
508	2-D	01T15249W01	Assy., Play Solenoid
509	4-D	01T10369W02	Assy., Eject Solenoid

Notes: ● ; For GR75E020 model only ■ ; For GR75E010 model only  
▲ ; For GR75E01A model only Others ; CommonNotes: ● ; For GR75E020 model only ■ ; For GR75E010 model only  
▲ ; For GR75E01A model only Others ; Common



# Exploded View (GR75L Series) (2/4)

● For GR75L020/02A Models

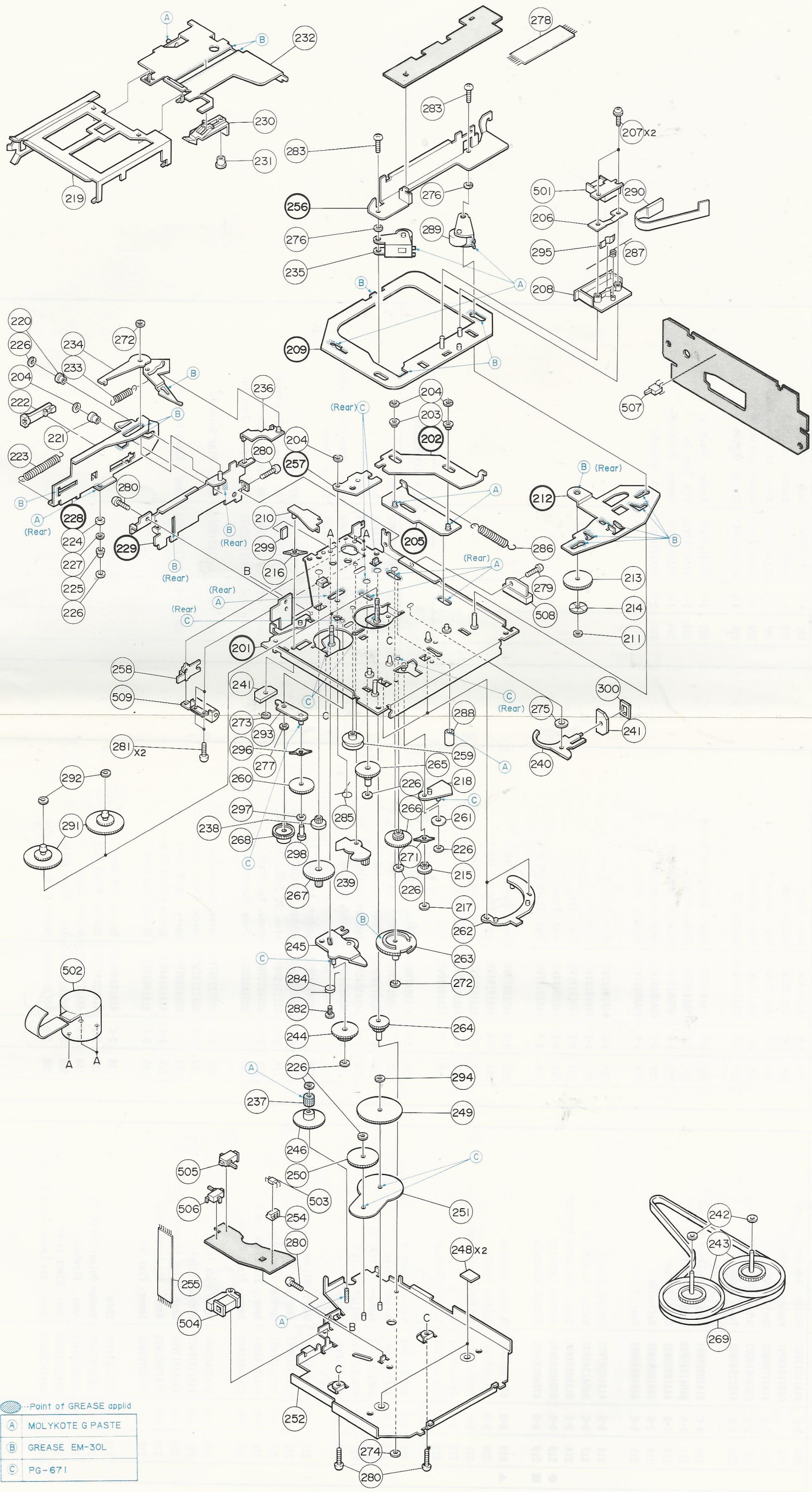

●	Point of GREASE applid
A	MOLYKOTE G PASTE
B	GREASE EM-30L
C	PG-67I



## Cassette Deck Assembly Parts List (GR75L Series) (2/4)

Note: The parts without parts list are not supplied.

Symbol No.	IN-dex	Part No.	Description
203	3-C	43A11072W01	Roll, Sub Head
204		04B41345P01	Washer, Lock(M1.2)
206	2-B	41A31756W01	Spring, Head
207	2-B	03S40019G03	Screw, F-Locks(M2x4)
208	2-B	43B12545W01	Tape, Guide
210	4-C	01A10206W01	Assy., Riv Lever R/F Sol.
211	2-D	04B41345P29	Washer, Lock(M2.6)
213	2-D	44A10295W01	Gear, Sensor
214	2-D	14A10681W01	Reflector
215	3-E	44A30480W01	Gear, Planet
216	3-E	41A10097W02	Spring, Clutch
217	3-E	04B41345P35	Washer, Lock(M1.7)
218	3-E	01A30824W01	Assy., Riv Lever Reverse
219	4-B	07B40283W01	Holder, Cassette
220	5-B	43A12583W01	Roller, Eject
221	5-C	43A63281F01	Roller, Plate Base
222	5-C	44A82206F01	Rack
223	5-C	41B10386W03	Spring, GR(Rack)
224	4-C	43A10121W01	Roller, Eject(A)
225	4-D	43A10360W01	Roller, Eject(B)
226		04B41345P11	Washer, Lock(M1.2)
227	4-D	43A12377W01	Roller, Eject(C)
230	4-A	45B10376W01	Slider
231	4-B	47A63278F01	Shaft, Slider
232	4-A	01A10212W01	Assy., Riv Plate Base
233	4-C	41B10386W01	Spring, Eject Arm
234	4-B	01A21754W01	Assy., Riv Eject Arm(A)
235	3-B	01B30863W02	Assy., Pinch Roller
236	4-C	45A10087W01	Lever, Pack In SW.
237	4-F	44A20314W01	Pinion, Eject
238	4-E	44A13617W01	Gear, Motor Idler(B)
239	3-E	01A10201W02	Assy., Riv Lever Pause
240	2-E	45A40725W01	Lever, Play Sol
241		76T10374W01	Chip
242	1-G	04S40075G05	Washer, Polyslider(M2.1)
243	1-G	01A10368W01	Assy., Flywheel
244	3-F	44A10141W01	Gear, Eject Idler
245	3-E	01A10205W02	Assy., Riv Lever Clutch(A)
246	3-F	44A10145W01	Gear, Eject
248	3-G	43A41656W01	Spacer, UHMW

Symbol No.	IN-dex	Part No.	Description
249	3-F	44A11063W01	Gear, Bottom(A)
250	3-F	44A11064W01	Gear, Bottom(B)
251	3-G	34A11122W02	Washer, GR
252	3-H	01A10210W02	Assy., Riv. Cover Bottom
254	3-G	15B11065W01	Guide, Photo
255	4-G	30T15126W01	Wire, PC Sensor(7P)
258	4-D	45A10101W01	Lever, Eject Sol.
259	3-D	49A10131W01	Pulley, Idler
260	4-E	44A10133W01	Gear, Take Up
261	3-E	44A10134W01	Gear, Sun
262	3-E	44B10135W01	Gear, Fix
263	3-E	44B21670W01	Gear, Pause
264	3-F	44A10137W01	Gear, Pause Idler(A)
265	3-D	44A10379W01	Gear, Pause Idler(B)
266	3-E	44A10138W01	Gear, Reverse Idler
267	3-E	44A10139W01	Gear, Motor Idler
268	4-E	44A11062W01	Gear, Reel Idler
269	1-G	42A10380W01	Belt, GR
271	3-E	41A30475W01	Spring, Clutch
272	3-F	04B41345P15	Washer, Lock(M1.2)
273	4-D	04B41345P02	Washer, Lock(M1.7)
274	3-H	04B41345P17	Washer, Lock(M1)
275	2-D	04B41345P30	Washer, Lock(M3.1)
276		04B41345P32	Washer, Lock(M3.1)
277	4-E	04B41345P37	Washer, Lock(M2.1)
278	2-A	30T15126W02	Wire, PC Joint 7P
279	2-D	03S44205G78	Screw, Pan(M2x6)
280		03S44205G30	Screw, Pan(M2.6x4)
281	4-D	03S72235F53	Screw, Pan(M2x3.3)
282	3-F	03A12132W02	Screw, Eject Clutch(M2x2.3)
283		03S43997P64	Screw, Pan(M1.7x3)
284	3-F	41A10384W01	Spring, Eject Clutch
285	3-E	41A10385W01	Spring, Cas. Push
286	2-C	41B10386W02	Spring, Sub Head
287	2-B	41A10387W01	Spring, Pinch Roller
288	3-D	43A12719W01	Roller, Pause
289	3-B	01B30863W01	Assy., Pinch Roller
290	2-B	84T25151W01	Head P.C. Board
291	4-E	01T35403W02	Assy., Reel
292	4-E	04B41345P12	Washer, Lock(M1.7)

Notes : ◆; For GR75L020 model only    ○; For GR75L02A model only  
Others; Common

Symbol No.	IN-dex	Part No.	Description
293	4-D	01A30161W01	Assy., Riv Lever Take Up
294	3-F	04B41345P34	Washer, Lock(M1.2)
295	2-B	26A20537W01	Shield, Plate
296	4-D	41A40910W01	Spring, Clutch
297	4-E	43A41543W01	Washer, Som(M1.2)
298	3-E	47A41458W01	Pin, Take Up
299	3-D	43A40388W01	Spacer, Polyslider
300	2-D	43A41744W01	Lock, Solenoid
Miscellaneous			
501	2-B	88T15971W01	Head
◆ 502	4-E	01V23900W60	Assy., Motor(13.2V-105mA)
○ 502	4-E	01V43400W37	Assy., Motor(13.2V-88mA)
503	3-G	51T15144W01	Sensor, Photo
504	4-G	01T10371W01	R/F Sol. Assy
505	4-F	40T15382W01	SW., Detector (Pack Down)
506	4-G	40T15382W01	SW., Detector (Metal)
507	2-C	40T15222W01	SW., Detector (Pack In)
508	2-D	01T15249W01	Assy., Play Solenoid
509	4-D	01T10369W02	Assy., Eject Solenoid

Notes : ◆; For GR75L020 model only    ○; For GR75L02A model only  
Others; Common

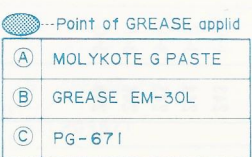

GR/GR-Y  
SeriesGR/GR-Y  
Series



## Cassette Deck Assembly Parts List (GR-Y Series) (3/4)

Note: The parts without parts list are not supplied.

Symbol No.	IN-dex	Part No.	Description
203	3-C	43A11072W01	Roll. Sub Head
204		04B41345P01	Washer. Lock(M1.2)
206	2-B	41A31756W01	Spring. Head
207	2-B	03S40019G03	Screw. F-Locks(M2x4)
208	2-B	43B12545W01	Tape. Guide
210	4-C	01A10206W01	Assy.. Riv Lever R/F Sol.
211	2-D	04B41345P29	Washer. Lock(M2.6)
213	2-D	44A10295W01	Gear. Sensor
214	2-D	14A10681W01	Reflector
215	3-E	44A30480W01	Gear. Planet
216		41A10097W02	Spring. Clutch
217	3-E	04B41345P35	Washer. Lock(M1.7)
218	3-E	01A30824W01	Assy.. Riv Lever Reverse
219	4-B	07B40283W01	Holder. Cassette
220	5-B	43A12583W01	Roller. Eject
221	5-C	43A63281F01	Roller. Plate Base
222	5-C	44A82206F01	Rack
223	5-C	41B10386W03	Spring. GR(Rack)
224	4-C	43A10121W01	Roller. Eject(A)
225	4-D	43A10360W01	Roller. Eject(B)
226		04B41345P11	Washer. Lock(M1.2)
227	4-D	43A12377W01	Roller. Eject(C)
230	4-A	45B10376W01	Slider
231	4-B	47A63278F01	Shaft. Slider
232	4-A	01A10212W01	Assy.. Riv Plate Base
233	4-C	41B10386W01	Spring. Eject Arm
234	4-B	01A21754W01	Assy.. Riv Eject Arm(A)
235	3-B	01B30863W02	Assy.. Pinch Roller
236	4-C	45A10087W01	Lever. Pack In SW.
237	4-F	44A20314W01	Pinion. Eject
238	4-E	44A13617W01	Gear. Motor Idler(B)
239	3-E	01A10201W02	Assy.. Riv Lever Pause
240	2-D	45A40725W01	Lever. Play Sol.
241		76T10374W01	Chip
242	1-G	04S40075G05	Washer. Polyslider(M2.1)
243	1-G	01A10368W01	Assy.. Flywheel
244	3-F	44A10141W01	Gear. Eject Idler
245	3-E	01A10205W02	Assy.. Riv Lever Clutch(A)
246	3-F	44A10145W01	Gear. Eject
248	3-G	43A41656W01	Spacer. UHMW

Symbol No.	IN-dex	Part No.	Description
249	3-F	44A11063W01	Gear. Bottom(A)
250	3-F	44A11064W01	Gear. Bottom(B)
251	3-G	34A11122W02	Washer. GR
252	3-H	01A10210W02	Assy.. Riv. Cover Bottom
254	3-G	15B11065W01	Guide. Photo
255	4-G	30T15126W01	Wire. PC Sensor(7P)
258	4-D	45A10101W01	Lever. Eject Sol.
259	3-D	49A10131W01	Pulley. Idler
260	4-E	44A10133W01	Gear. Take Up
261	3-E	44A10134W01	Gear. Sun
262	3-E	44B10135W01	Gear. Fix
263	3-E	44B21670W01	Gear. Pause
264	3-F	44A10137W01	Gear. Pause Idler(A)
265	3-D	44A10379W01	Gear. Pause Idler(B)
266	3-E	44A10138W01	Gear. Reverse Idler
267	3-E	44A10139W01	Gear. Motor Idler
268	4-E	44A11062W01	Gear. Reel Idler
269	1-G	42A10380W01	Belt. GR
271	3-E	41A30475W01	Spring. Clutch
272	3-F	04B41345P15	Washer. Lock(M1.2)
273		04B41345P02	Washer. Lock(M1.7)
274	3-H	04B41345P17	Washer. Lock(M1)
275	2-D	04B41345P30	Washer. Lock(M3.1)
276	3-B	04B41345P32	Washer. Lock(M3.1)
277	4-E	04B41345P37	Washer. Lock(M2.1)
278	2-A	30T15126W02	Wire. PC Joint 7P
279	2-D	03S44205G78	Screw. Pan(M2x6)
280		03S44205G30	Screw. Pan(M2.6x4)
281	4-D	03S72235F53	Screw. Pan(M2x3.3)
282	3-F	03A12132W02	Screw. Eject Clutch(M2x2.3)
283		03S43997P64	Screw. Pan(M1.7x3)
284	3-F	41A10384W01	Spring. Eject Clutch
285	3-E	41A10385W01	Spring. Cas. Push
286	2-C	41B10386W02	Spring. Sub Head
287	2-B	41A10387W01	Spring. Pinch Roller
288	3-D	43A12719W01	Roller. Pause
289	3-B	01B30863W01	Assy.. Pinch Roller
290	2-B	84T35271W01	Head P.C. Board
291	4-E	01T35403W02	Assy.. Reel
292	4-E	04B41345P12	Washer. Lock(M1.7)

Symbol No.	IN-dex	Part No.	Description	
293	4-D	01A30161W01	Assy.. Riv Lever Take Up	
294	3-F	04B41345P34	Washer, Lock(M1.2)	
295	2-B	26A20537W01	Shield, Plate	
296	4-D	41A40910W01	Spring, Clutch	
297	4-E	43A41543W01	Washer, Som(M1.2)	
298	3-E	47A41458W01	Pin, Take Up	
299	3-C	43A40388W01	Spacer, Polyslider	
300	2-D	43A41744W01	Lock, Solenoid	
301	2-B	41A41416W01	Spring, Head	
Miscellaneous				
☆	501	2-B	88T15971W01	Head
◇	502	4-E	01V23900W60	Assy.. Motor(13.2V-105mA)
	502	4-E	01V44200W73	Assy.. Motor(13.2V-80mA)
	503	3-G	51T15144W01	Sensor, Photo
	504	4-G	01T10371W01	R/F Sol. Assy
	505	4-F	40T15382W01	SW., Detector (Pack Down)
	506	4-G	40T15382W01	SW., Detector (Metal)
	507	2-C	40T15222W01	SW., Detector (Pack In)
	508	2-D	01T15249W01	Assy.. Play Solenoid
	509	4-D	01T10369W02	Assy.. Eject Solenoid

Notes:☆; For GR75L02Y model only ◇; For GR75L52Y model only

Others; Common

Notes:☆; For GR75L02Y model only ◇; For GR75L52Y model only

Others; Common



# Exploded View (GR75H Series) (4/4)

● For GR75H030/020/130/110/120/12A/13A Model

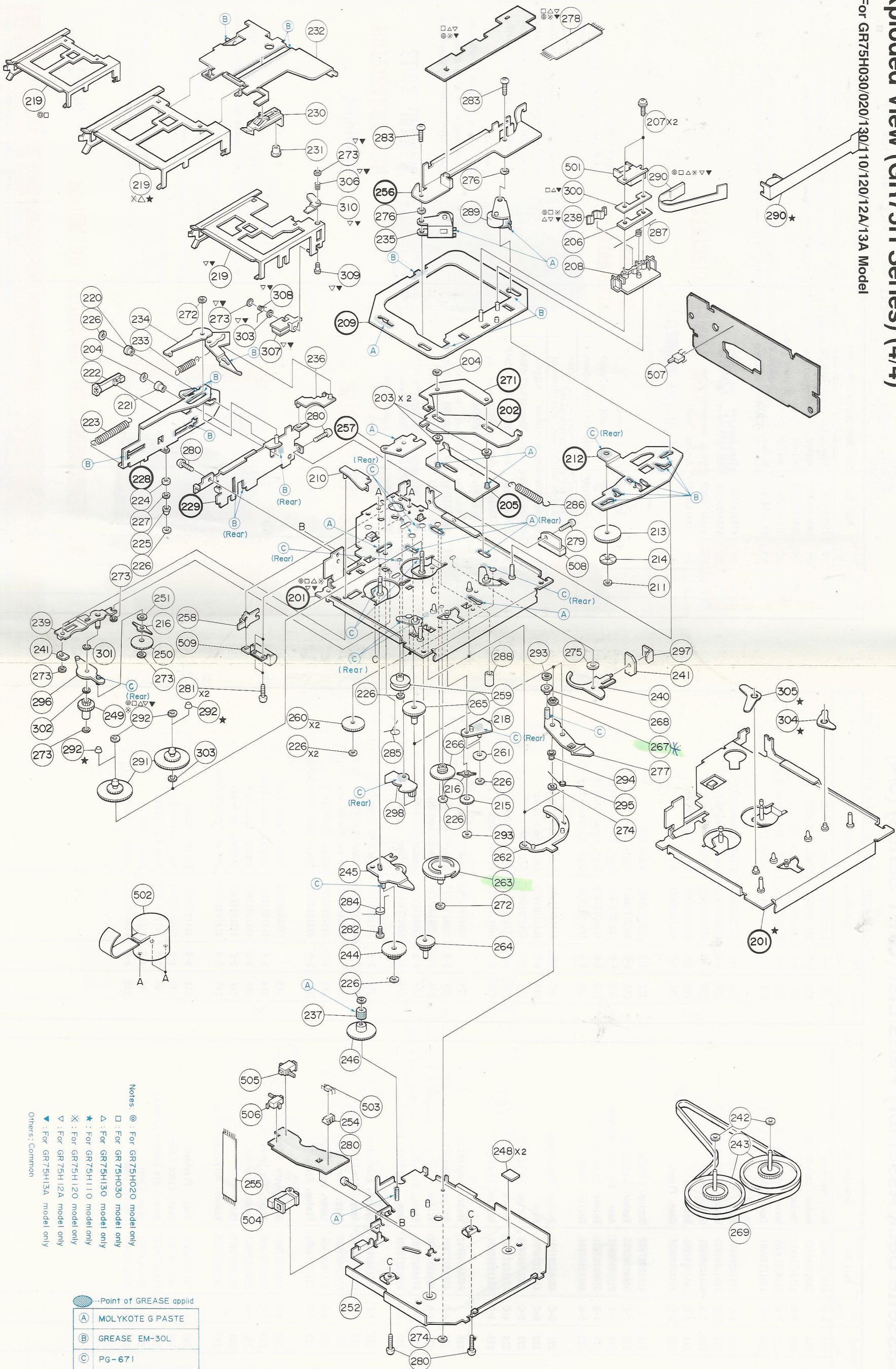

Notes: ● : For GR75H020 model only

□ : For GR75H030 model only

△ : For GR75H130 model only

★ : For GR75H110 model only

× : For GR75H120 model only

▽ : For GR75H12A model only

▲ : For GR75H13A model only

Others: Common

●	Point of GREASE applid
A	MOLYKOTE G PASTE
B	GREASE EM-30L
C	PG-67I



# Cassette Deck Assembly Parts List (GR75H Series) (4/4)

Note: The parts without parts list are not supplied.

Symbol No.	IN-dex	Part No.	Description
◎ 203	3-C	43A51119W01	Roller, Sub Head
□ 203	3-C	43A51119W01	Roller, Sub Head
※ 203	3-C	43A31453W01	Roller, Sub Head
△ 203	3-C	43A31453W01	Roller, Sub Head
▽ 203	3-C	43A31453W01	Roller, Sub Head
▼ 203	3-C	43A31453W01	Roller, Sub Head
★ 203	3-C	43A31453W01	Roller, Sub Head
204		04B41345P01	Washer, Lock(M1.2)
206	2-B	41A31756W01	Spring, Head
207	2-A	03A38021W01	Screw, Flange(M2x4)
208	2-B	43B12545W01	Tape, Guide
210	4-C	01A30462W01	Assy., Riv Lever R/F Sol
211	2-D	04B41345P29	Washer, Lock(M2.6)
213	2-D	44A10295W01	Gear, Sensor
214	2-D	14A58039W01	Reflector
215	3-E	44A30480W01	Gear, Planet
216		41A30475W01	Spring, Clutch
218	3-E	01A30824W01	Assy., Riv Lever Reverse
◎ 219	5-A	07B40283W01	Holder, Cassette
□ 219	5-A	07B40283W01	Holder, Cassette
△ 219	5-B	07B40012W01	Holder, Cassette
※ 219	5-B	07B40012W01	Holder, Cassette
★ 219	5-B	07B40012W01	Holder, Cassette
▽ 219	4-B	01A51158W01	Assy., Riv Cassete Holder
▼ 219	4-B	01A51158W01	Assy., Riv Cassete Holder
220	5-B	43A12583W01	Roller, Eject
221	5-C	43A63281F01	Roller, Plate Base
222	5-C	44A82206F01	Rack
◎ 223	5-C	41B10386W03	Spring, GR(Rack)
□ 223	5-C	41B10386W03	Spring, GR(Rack)
△ 223	5-C	41B10386W04	Spring, GR(Rack)
★ 223	5-C	41B10386W04	Spring, GR(Rack)
※ 223	5-C	41B10386W04	Spring, GR(Rack)
▽ 223	5-C	41B10386W04	Spring, GR(Rack)
▼ 223	5-C	41B10386W04	Spring, GR(Rack)
224	5-C	43A10121W01	Roller, Eject A
225	5-D	43A10360W01	Roller, Eject B
226		04B41345P11	Washer, Lock(M1.2)
227	5-D	43A12377W01	Roller, Eject C
230	4-A	45B10376W01	Slider
231	4-B	47A63278F01	Shaft, Slider
◎ 232	4-A	01A10212W01	Assy., Riv Plate Base
□ 232	4-A	01A10212W01	Assy., Riv Plate Base
△ 232	4-A	01A40024W01	Assy., Riv Plate Base
★ 232	4-A	01A40024W01	Assy., Riv Plate Base

Symbol No.	IN-dex	Part No.	Description
※ 232	4-A	01A40024W01	Assy., Riv Plate Base
▽ 232	4-A	01A40024W01	Assy., Riv Plate Base
▼ 232	4-A	01A40024W01	Assy., Riv Plate Base
◎ 233	5-C	41B10386W01	Spring, Eject Arm
□ 233	5-C	41B10386W01	Spring, Eject Arm
△ 233	5-C	41B63283F11	Spring
★ 233	5-C	41B63283F11	Spring
※ 233	5-C	41B63283F11	Spring
▽ 233	5-C	41B63283F11	Spring
▼ 233	5-C	41B63283F11	Spring
◎ 234	5-C	01A30883W01	Assy., Riv Eject Arm B
□ 234	5-C	01A30883W01	Assy., Riv Eject Arm B
△ 234	5-C	01A40021W01	Assy., Riv Eject Arm D
★ 234	5-C	01A40021W01	Assy., Riv Eject Arm D
※ 234	5-C	01A40021W01	Assy., Riv Eject Arm D
▽ 234	5-C	01A40021W01	Assy., Riv Eject Arm D
▼ 234	5-C	01A40021W01	Assy., Riv Eject Arm D
235	3-B	01B30863W02	Assy., Pinch Roller
236	4-C	45A10087W01	Lever Pack In SW
237	4-F	44A20314W01	Pinion, Eject
◎ 238	2-B	26A20537W01	Shield, plate
□ 238	2-B	26A20537W01	Shield, plate
※ 238	2-B	26A20537W01	Shield, plate
△ 238	2-B	26A20537W01	Shield, plate
▽ 238	2-B	26A20537W01	Shield, plate
▼ 238	2-B	26A20537W01	Shield, plate
239	5-D	01A40881W01	Assy., Riv RF Link
240	2-D	45A40725W01	Lever, Play Sol.
241		76T10374W01	Chip
◎ 242	1-G	04S40075G05	Washer, Polyslider(M2.1)
□ 242	1-G	04S40075G05	Washer, Polyslider(M2.1)
※ 242	1-G	04S40075G05	Washer, Polyslider(M2.1)
△ 242	1-G	04S40075G05	Washer, Polyslider(M2.1)
▽ 242	1-G	04S40075G05	Washer, Polyslider(M2.1)
▼ 242	1-G	04S40075G05	Washer, Polyslider(M2.1)
★ 242	1-G	04T55449W01	Washer, Teflon(M2.1)
◎ 243	1-G	01A30488W01	Assy., Flywheel
□ 243	1-G	01A30488W01	Assy., Flywheel
※ 243	1-G	01A30488W01	Assy., Flywheel
△ 243	1-G	01A30488W01	Assy., Flywheel
▽ 243	1-G	01A30488W01	Assy., Flywheel
▼ 243	1-G	01A30488W01	Assy., Flywheel
★ 243	1-G	01A50658W01	Assy., Flywheel
244	3-F	44A10141W01	Gear, Eject Idler
245	3-E	01A10205W02	Assy., Riv Lever Clutch A

Notes: ◎ ; For GR75H020 model only □ ; For GR75H030 model only

▽ ; For GR75H12A model only △ ; For GR75H130 model only

★ ; For GR75H110 model only ※ ; For GR75H120 model only

▼ ; For GR75H13A model only Others ; Common



Note : The parts without parts list are not supplied.

Symbol No.	IN- dex	Part No.	Description	
	246	3-F	44A10145W01	Gear, Eject
	248	3-G	43A41656W01	Spacer, UHMW
	249	5-E	44A30481W01	Gear, RF Idler
	250	4-D	44A30483W01	Gear, RF
	251	4-D	04S40075G58	Washer, Polyslider(M2.1)
	252	3-H	01A30463W01	Assy., Riv. Cover Bottom
	254	3-G	15B11065W01	Guide, Photo
	255	4-G	30T15126W01	Wire, PC Sensor(7P)
	258	4-D	45A10101W01	Lever, Eject Sol
	259	3-D	49A30476W01	Pulley, Idler
	260	4-E	44A30482W01	Gear, Take Up
	261	3-E	44A30478W01	Gear, Sun
◎	262	3-E	44B10135W01	Gear, Fix
□	262	3-E	44B10135W01	Gear, Fix
★	262	3-E	44B10135W01	Gear, Fix
※	262	3-E	44B10135W01	Gear, Fix
△	262	3-E	44B10135W01	Gear, Fix
▼	262	3-E	44B10135W01	Gear, Fix
▽	262	3-E	44B10135W02	Gear, Fix
	263	3-E	44B30484W01	Gear, Pause
	264	3-F	44A10137W01	Gear, Pause Idler A
	265	3-E	44A30486W01	Gear, Pause Idler B
	266	3-E	44A30479W01	Gear, Reverse Idler
	267	2-E	44A30485W01	Gear, Motor Idler
	268	2-E	44A30487W01	Gear, Motor Clutch
	269	1-G	42A31850W01	Belt, GR
	272		04B41345P15	Washer, Lock(M1.2)
	273		04B41345P02	Washer, Lock(M1.7)
	274		04B41345P17	Washer, Lock(M1)
	275	2-D	04B41345P30	Washer, Lock(M3.1)
	276		04B41345P32	Washer, Lock(M3.1)
	277	2-E	01A30464W01	Assy., Riv Play Clutch
◎	278	2-A	30T15126W02	Wire, PC Joint 7P
□	278	2-A	30T15126W02	Wire, PC Joint 7P
※	278	2-A	30T15126W02	Wire, PC Joint 7P
△	278	2-A	30T15126W02	Wire, PC Joint 7P
▽	278	2-A	30T15126W02	Wire, PC Joint 7P
▼	278	2-A	30T15126W02	Wire, PC Joint 7P
	279	2-D	03S44205G78	Screw, Pan(M2x6)
	280		03S44205G30	Screw, Pan(M2.6x4)
	281	4-D	03S72235F53	Screw, Pan(M2x3.3)
	282	3-F	03A12132W02	Screw, Eject Clutch(M2x2.3)
	283		03S43997P64	Screw, Pan(M1.7x3)
	284	3-F	41A10384W01	Spring, Eject Clutch
	285	3-E	41A10385W01	Spring, Cassette Push

Note: The parts without parts list are not supplied.				
Symbol	No.	IN-dex	Part No.	Description
	286	2-C	41B10386W02	Spring, Sub Head
	287	2-B	41A10387W01	Spring, Pinch Roller
	288	3-D	43A12719W01	Roller, Pause
	289	3-B	01B30863W01	Assy., Pinch Roller
◎	290	2-B	84T25151W01	Head P.C. Board
※	290	2-B	84T25151W01	Head P.C. Board
▽	290	2-B	84T25151W01	Head P.C. Board
□	290	2-B	84T35271W01	Head P.C. Board
△	290	2-B	84T35271W01	Head P.C. Board
▼	290	2-B	84T35271W01	Head P.C. Board
★	290	1-B	84T45462W01	Head P.C. Board
◎	291	5-E	01T35403W01	Assy., Reel
□	291	5-E	01T35403W01	Assy., Reel
※	291	5-E	01T35403W01	Assy., Reel
△	291	5-E	01T35403W01	Assy., Reel
▽	291	5-E	01T35403W01	Assy., Reel
▼	291	5-E	01T35403W01	Assy., Reel
★	291	5-E	01T45062W01	Assy., Reel
◎	292	5-E	04B41345P12	Washer, Lock(M1.7)
□	292	5-E	04B41345P12	Washer, Lock(M1.7)
※	292	5-E	04B41345P12	Washer, Lock(M1.7)
△	292	5-E	04B41345P12	Washer, Lock(M1.7)
▽	292	5-E	04B41345P12	Washer, Lock(M1.7)
▼	292	5-E	04B41345P12	Washer, Lock(M1.7)
★	292		49A40718W01	Reel, Cap
	293		04B41345P35	Washer, Lock(M1.7)
	294	2-E	43A30827W01	Spacer, Motor Idler
	295	2-E	41A30490W01	Spring, Play Clutch
	296	5-E	01A40882W01	Assy., Riv Lever RF
	297	2-D	43A41744W01	Lock, Solenoid
	298	3-E	01A10201W02	Assy, Riv Lever Pause
□	300	2-B	41A41416W01	Spring, Head
△	300	2-B	41A41416W01	Spring, Head
▼	300	2-B	41A41416W01	Spring, Head
	301	5-D	04S40075G63	Washer, Polyslider(M2.1)
	302	5-E	04S40075G62	Washer, Polyslider(M2.1)
	303		04S40075G05	Washer, Polyslider(M2.1)
★	304	1-E	01A50659W01	Assy., Riv Pinch Roller(N)
★	305	1-E	01A50660W01	Assy., Riv Pinch Roller(R)
▽	306	3-B	41A50970W01	Spring, Push Holder
▼	306	3-B	41A50970W01	Spring, Push Holder
▽	307	4-C	01A51160W01	Assy., Link Felt Guide
▼	307	4-C	01A51160W01	Assy., Link Felt Guide
▽	308	4-B	41A50969W01	Spring, Holder
▼	308	4-B	41A50969W01	Spring, Holder

Notes: © ; For GR75H020 model only    □ ; For GR75H030 model only  
 ▽ ; For GR75H12A model only    △ ; For GR75H130 model only

★ ; For GR75H110 model only      ※ ; For GR75H120 model only  
▼ ; For GR75H13A model only      Others ; Common



