

# AIR CHIEF

CAR RADIO DIVISION, ELECTRONIC INDUSTRIES LTD.

ASTOR HOUSE: 161-173 STURT STREET, SOUTH MELBOURNE Phone: 69 0300

## SERVICE DATA

### HOLDEN "FB"/"EK"

#### INSTALLATION INSTRUCTIONS FOR FITTING

#### AIR CHIEF 12 VOLT CAR RADIO

#### MODELS PD-C - - and MD-C - - "J" SERIES RECEIVERS

In addition to the selected receiver the installation requires:-

Installation Accessory Package: GMH Part No. 7426322

Aerial-5 section, telescopic whip, top mount type, GMH Part No.7419906

or Aerial-5 section, telescopic whip, lock down type, GMH Part No.M33308

**WARNING:** BATTERY CONNECTION OF INCORRECT POLARITY WILL DAMAGE THE RECEIVER.

Before commencing installation disconnect leads from car battery. Note the polarity of the battery terminal which is connected to vehicle chassis then set the receiver polarity changeover switch to corresponding position. i.e. "-" position, negative to chassis, "+" position, positive to chassis.

**NOTE:** AERIAL TRIMMER located on rear passenger side wall of receiver is to be adjusted at conclusion of installation.

**THE AERIAL :** As selected is to be mounted at the positions detailed.

#### 1 MOUNTING POSITION:

Top Mount Aerial Mark the fender at a position  $4\frac{3}{8}$ " forward from fender door join line and  $2\frac{3}{8}$ " outward from cowl join line.

Fully Retractable Aerial Mark the fender at a position 7" forward from fender door join line and 1" outward from the crest of fender form.

#### 2 Continue installation of aerial as detailed in instructions supplied with aerial.

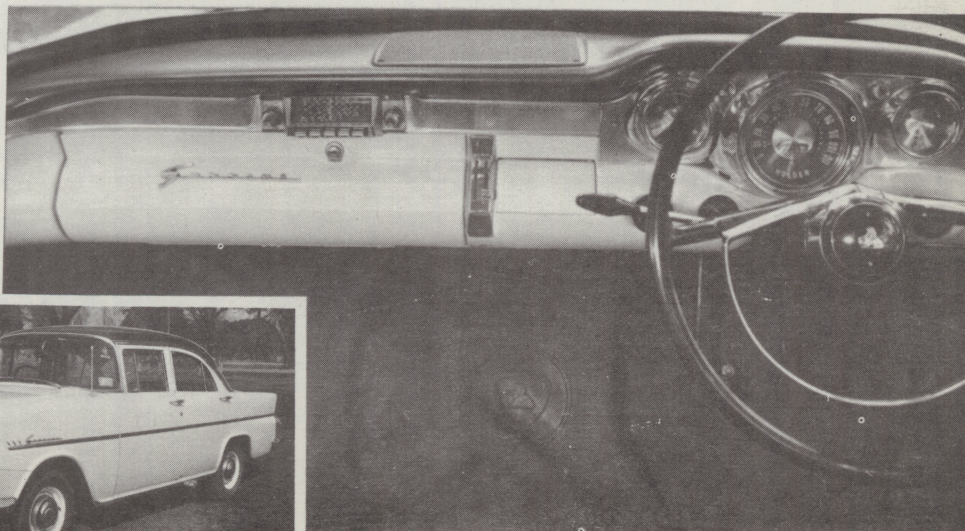



#### AERIAL LEAD-IN CABLE

- 1 Forward top of passenger side kick pad, there is a semi-sheared hole section; knock out the semi-sheared section, then mark passenger side wall corresponding to the centre of hole in kick pad.
- 2 If there is no semi-sheared section in kick pad, mark a position  $1\frac{1}{2}$ " toward front of car from drain hose situated above the kick pad. NOTE: The position to be marked is below the formed section of passenger side wall.
- 3 At the position marked on passenger side wall, drill a  $\frac{1}{2}$ " hole. Remove all burrs from around the  $\frac{1}{2}$ " hole.
- 4 Feed aerial cable through the  $\frac{1}{2}$ " hole into interior of car.
- 5 Pull the end of shroud grommet through the hole until head of grommet locates into the  $\frac{1}{2}$ " hole.

THE SPEAKER (9"x 6") is to be mounted below speaker grille situated on top section of instrument panel.

- 1 Remove glove box from instrument panel.
- 2 Remove the four Phillips hd. screws fastening speaker grille to top of instrument panel, then remove speaker grille from instrument panel.
- 3 Enlarge to  $\frac{1}{8}$ " dia. the hole nearest to passenger side and windscreen for grille attachment.
- 4 With speaker lead toward rear of car, insert speaker lead and speaker through opening in instrument panel; locate the four speednuts attached to speaker frame under the holes nearest to opening in panel.
- 5 Insert a  $\frac{3}{4}$ "x No.8 csk. hd. screw through each of the four holes in instrument panel into speednuts attached to speaker. Securely tighten screws.
- 6 Refit speaker grille to instrument panel and securely tighten the three Phillips head screws. Position the fourth screw so that it locates in enlarged hole.

THE RECEIVER is to be mounted to instrument panel in the position occupied by an oblong cover panel directly above the glove box. A folded bracket is supplied to support rear to screw attaching speaker grille.

- 1 Remove and discard oblong cover panel from instrument panel directly above glove box.
- 2 Refer diagram; remove metal from panel as indicated on diagram. Remove burrs from edges of finished cut.
- 3 Place the two spacer rings supplied on to the control bush lock nuts then fit dial pointer to carriage arm. Slide dust shield on top of receiver can forward then securely tighten the screw. Fit folded bracket to rear of receiver so that short fold is over and above receiver. Attach to back of receiver with a flat washer and  $\frac{1}{2}$ "x No.6 hex.hd.screw.
- 4 Place receiver behind instrument panel, then insert plug on end of speaker lead in to receiver socket adjacent to battery lead entry.
- 5 Move receiver toward rear of car so that control spindles protrude through holes in instrument panel.
- 6 Fit dial reading to chrome escutcheon. MANUAL RECEIVER ONLY: Fit filler bar to push button opening then securely fasten with speednuts.
- 7 Fit chrome escutcheon, then fit chrome washers and barrel nuts to receiver. Leave barrel nuts fingertight.
- 8 Align receiver to instrument panel. Securely tighten barrel nuts, then fit control knobs.
- 9 Align speednut on short fold of bracket with screw attaching speaker grille. Securely tighten screw.
- 10 Align receiver and tighten screw attaching bracket.
- 11 Insert fuse supplied into fuse holder, connect fuse holder to fuse cap on end of lead from receiver.

- 12 Feed lead through clip that holds windscreen wiper cable and along formed channel in bottom lip of instrument panel, then below clutch lever spring and up through hole in steering column brace plate to fuse block. Connect receiver battery lead to terminal marked "RADIO" on fuse block.
- 13 Insert body of fuse holder into the black clip supplied; pull excess receiver battery lead toward passenger side, then press clip on to small ledge pointing toward rear of car at top of glove box.
- 14 Insert aerial cable into socket on passenger side rear corner of receiver.
- 15 Insert aerial cable into plated clip supplied; press clip on to small ledge pointing toward rear of car at top of glove box so that it is directly below passenger side of receiver. Pull all excess cable toward aerial side of clip so that cable will be clear of windscreen wiper link when operating.
- 16 Refit glove box and securely tighten screws.

INTERFERENCE ELIMINATION: No spark plug suppressors are required.

WARNING: Distributor Suppressor: If the high tension leads are marked "TVRS", "GM Radio" or "Resistance Cable", a distributor suppressor MUST NOT be fitted.

Other type high tension leads require the inclusion of a distributor suppressor which should be fitted to the leads as follows:- Insert a screw-in type suppressor, P/No. 4021-012-01 in the high tension lead from the ignition coil a few inches from where it enters the distributor. Make sure the lead is fitted well in to the suppressor, and that good contact is made. Securely bind both ends of suppressor to the lead with adhesive tape.

Generator capacitor: .5mF Part No. 4009-024-09 (open ended slot in mount bracket) Remove earth terminal screw provided on top of generator. Remove and discard the spring washer. Place a 5/8" O.D. flat washer and a 1/4" ext. sh/proof washer on to screw. Refit screw to generator, then insert capacitor mount foot between flat washer and the 1/4" ext. sh/proof washer. Securely tighten screw. Connect lug on end of lead to armature terminal, NOT THE FIELD TERMINAL. Loosen off armature terminal nut, then insert lug on end of lead beneath terminal nut. Press lug hard against terminal post, then securely tighten the nut.

Ignition coil capacitor: .5mF Part No. 4009-024-08 (hole in mount bracket.) Insert a 1/4"x No.8 bdr. hd. screw through hole in capacitor mount bracket. Place a 5/32" ext. sh/proof washer on to screw, then insert screw into hole in formed section of ignition coil mount strap. Securely tighten screws. Loosen off battery terminal, then insert lug on end of lead beneath terminal nut. Press lug hard against terminal post, then securely tighten the nut.

Reconnect leads to car battery.

AERIAL TRIMMER ADJUSTMENT: Raise aerial to half extended height. NOTE: If a fully retractable aerial is fitted raise the large diameter outer tube until it is against stop in aerial base. Tune receiver to a weak station near 1000 Kc/s (approximately centre of dial) adjust trimmer for maximum volume of signal.

HOLDEN "FB-EK" TEMPLATE

PLACE ESCUTCHEON OVER OPENING, MARK & REMOVE  
METAL FROM SPINDLE HOLES. REMOVE EXCESS METAL  
AS SHOWN.

PB1209.

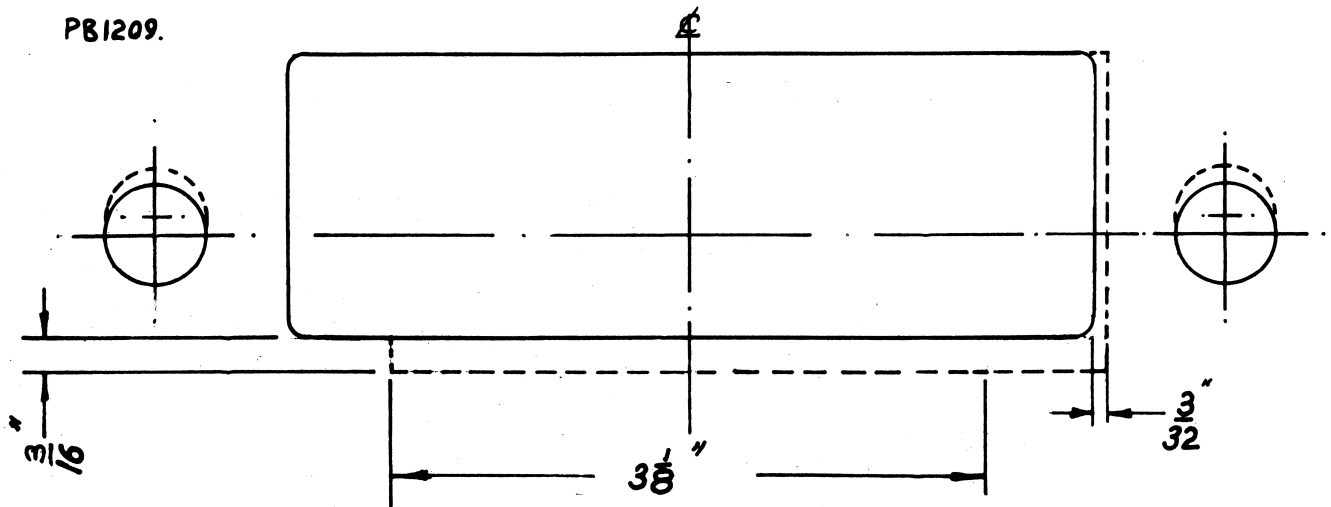



# HOLDEN "FB"/"EK"

## MODELS PD-C - - and MD-C - - "J" SERIES RECEIVERS

### COMPONENT PARTS LIST

4077-093-72 Aerial Lead-in Cable (1) 42" overall  
7138-043-01 Clip (1) lead-in cable

### SPEAKER AND MOUNTING ACCESSORIES

4056-004-18 Speaker (1) 9"x6" permag type C96L36/69/15  
7171-015-02 Plug (1) on end of lead  
7244-034-01 Terminal (2) on end of lead  
1171-023-08 Lead - 18" required  
7201-229-06 Screw (4)  $\frac{3}{4}$ "x No. 8 csk. hd.  
7152-512-01 Speednut (4)

### RECEIVER MOUNTING ACCESSORIES

7055-425-02 Spacer Ring (2) control bush lock nut  
7173-042-05 Dial Pointer (1)  
7070-115-21 Dial Reading (1)  
7084-178-01 Dial Escutcheon Assy. (1)  
includes:-  
7081-001-01 "Diamond Dot" emblem  
7008-123-02 "AIRCHIEF" metcal  
7261-484-02 Chrome Washer (2)  
7150-854-20 Barrel Nut (2)  
7027-610-03 Bracket (1) rear  
7152-752-01 Speednut (1) No. 6 captive  
7201-027-11 Screw (1)  $\frac{1}{2}$ "x No. 6 hex. hd.  
7261-160-02 Washer (1) flat steel, 9/16"x11/64"  
7124-425-01 Knob (2) antiference and tone, rear  
7124-424-11 Knob (2) tuning and volume, front  
4071-010-01 Fuse (1) 3 Amp.  
7113-001-01 Fuse Holder Body (1)  
7086-125-04 Contact (1) fuse holder  
7255-012-02 Spring (1) fuse holder  
1169-051-08 Lead - 54" required.  
7244-003-01 Terminal (1) on end of lead  
7291-003-01 Shroud (1) Terminal  
7055-365-01 Clip (1) lead anchor.

### INTERFERENCE ELIMINATION ACCESSORIES

4009-024-09 .5uF Capacitor, generator by-pass  
4009-024-08 .5uF Capacitor, ignition coil by-pass  
4021-012-01 Suppressor resistor, distributor  
7261-026-03 Washer (1) flat steel, 5/8"x 17/64"  
7262-516-02 Washer (1) shakeproof,  $\frac{1}{4}$ " ext.  
7209-522-11 Screw (1)  $\frac{1}{4}$ "x No. 8 bdr. hd.  
7262-510-02 Washer (1) shakeproof, 5/32" ext.

### COMPONENTS SUPPLIED WITH RECEIVER.

7119-046-01 Filler Bar (1) manual receiver escutcheon.  
7152-272-01 Speednut (2) filler bar fastening  
7065-011-01 Fuse Holder Cover (1)  
7086-125-01 Contact (1) fuse cover