

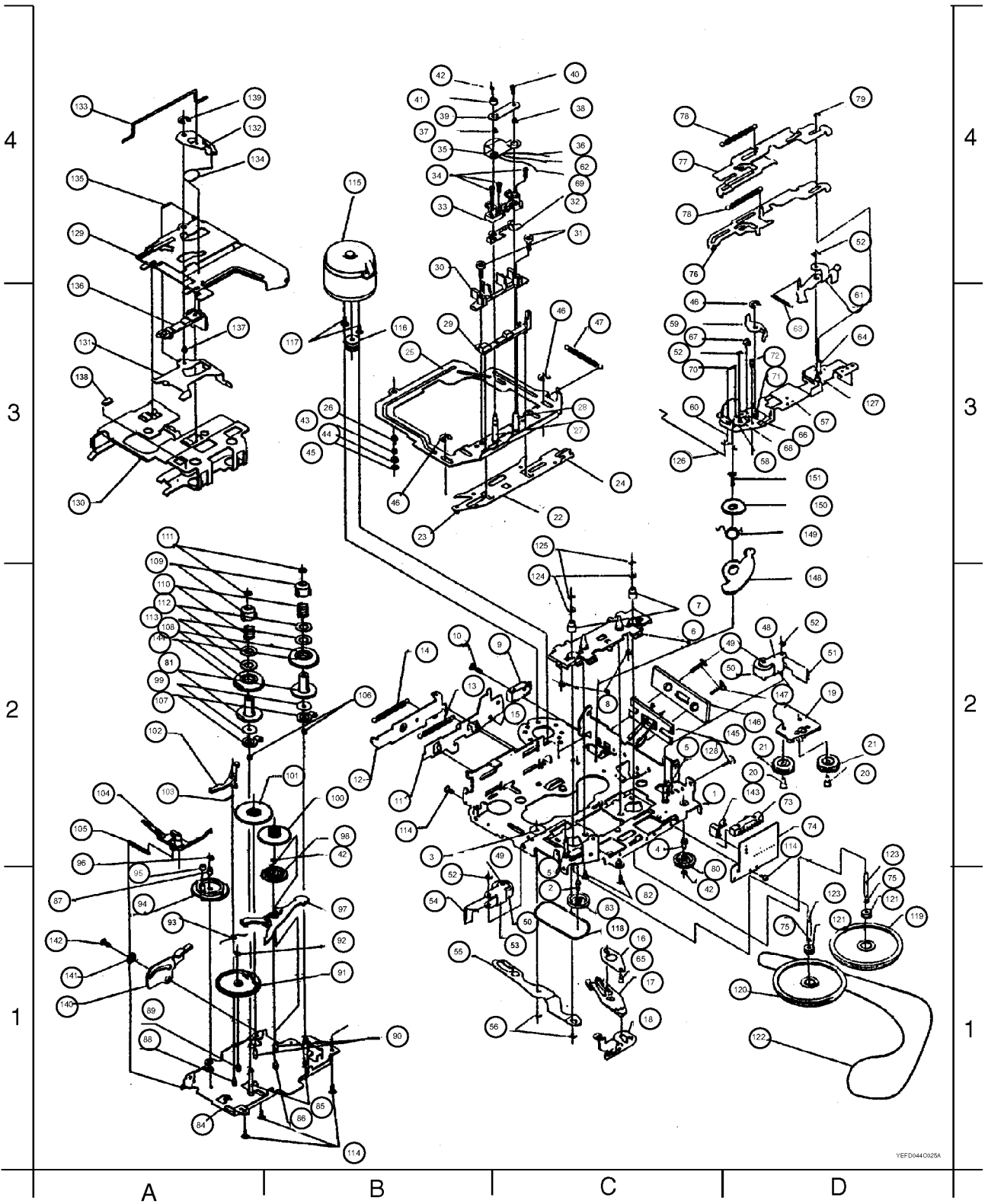

Supplement



Note:

1. Be sure to make your orders of replacement parts according to this list.
2. Important safety notice: Component , indentified by  mark have special characteristics important for safety. when replacing any of these components, use only manufacturer's specified parts.
3. Location keys in the remarks column indicates the general location of the parts shown in the exploded drawing. as in a load map.
4. "T" marks in remarks colum are indicated supply parts of TAMACO.